

BUILDING DATA

PROJECT DESCRIPTION		BUILDING OCCUPANCY			BUILDING DESCRIPTION					FIRE ALARM SYSTEM FEATURES	
	NEW BUILDING		ASSEMBLY GROUP A (A1,A2,A3,A4 AND A5)		RESIDENTIAL GROUP R (R1,R2 AND R3)	3	TOTAL NUMBER OF LEVELS		ATRIUM		NON-VOICE EVACUATION
	FIRE ALARM SYSTEM UPGRADE	X	BUSINESS GROUP B (ANIMAL HOSPITAL)		STORAGE GROUP S (S1 AND S2)	2	ABOVE GROUND LEVELS	FIRST FL	FIRE DEPARTMENT ACCESS		VOICE EVACUATION
	LIFE SAFETY SYSTEM UPGRADE		EDUCATIONAL GROUP E		UTILITY AND MISCELLANEOUS GROUP U	1	BELOW GROUND LEVELS	X	FULLY SPRINKLERED		PARTIAL/SELECTIVE EVACUATION
X	RENOVATION		FACTORY INDUSTRIAL GROUP F (F1 AND F2)		OTHER:	2	NUMBER OF ELEVATOR BANKS		PARTIALLY SPRINKLERED	X	GENERAL EVACUATION
	EMERGENCY REPAIR		HIGH-HAZARD GROUP H (H1,H2,H3,H4 AND H5)			2	NUMBER OF EGRESS STAIRS		NON-SPRINKLERED		DIGITAL ALARM COMMUNICATOR
	TENANT ADDITION		INSTITUTIONAL GROUP I (I1,I2 AND I3)			X	LOW RISE BUILDING		PRE-ACTION SPRINKLER		PRE-SIGNAL SYSTEM
	OTHER:		MERCANTILE GROUP M				HIGH RISE BUILDING				FIRE FIGHTER'S TELEPHONE SYSTEM

FIRE ALARM I/O MATRIX

SYSTEM INPUTS INITIATING DEVICES		SYSTEM OUTPUTS INDICATING/CONTROLLED DEVICES		CONTROL UNIT ANNUNCIATION				NOTIFICATION								REQUIRED FIRE SAFETY CONTROL			
				ACTIVATE COMMON ALARM SIGNAL INDICATOR ON LCD OF FIRE ALARM CONTROL PANEL & OUTLYING ANNUNCIATORS	ACTIVATE COMMON SUPERVISORY SIGNAL INDICATOR ON LCD OF FIRE ALARM CONTROL PANEL & OUTLYING ANNUNCIATORS	ACTIVATE COMMON TROUBLE SIGNAL INDICATOR ON LCD OF FIRE ALARM CONTROL PANEL & OUTLYING ANNUNCIATORS	SOUND INTERNAL BUZZER AT FIRE ALARM CONTROL PANEL & OUTLYING ANNUNCIATORS	TEXT MESSAGE DISPLAY DEVICE TYPE & LOCATION OF THE ACTIVATING DEVICES ON LCD OF FIRE ALARM CONTROL PANEL & OUTLYING ANNUNCIATORS	DISPLAY/PRINT THE TEXT MESSAGE VIA THE SYSTEM PRINTER	ACTIVATE EVACUATION SIGNAL THROUGH HORN AND FLASH THE STROBES ON ALARM ALL FLOOR	TRANSMIT "MANUAL" ALARM SIGNAL TO FIRE DEPARTMENT VIA AN APPROVED CENTRAL STATION MONITORING COMPANY	TRANSMIT "SMOKE" ALARM SIGNAL TO FIRE DEPARTMENT VIA AN APPROVED CENTRAL STATION MONITORING COMPANY	TRANSMIT "WATER LOW" ALARM SIGNAL TO FIRE DEPARTMENT VIA AN APPROVED CENTRAL STATION MONITORING COMPANY	TRANSMIT "SUPERVISORY" ALARM SIGNAL TO FIRE DEPARTMENT VIA AN APPROVED CENTRAL STATION MONITORING COMPANY	TRANSMIT "TROUBLE" ALARM SIGNAL TO FIRE DEPARTMENT VIA AN APPROVED CENTRAL STATION MONITORING COMPANY	ACTIVATE EVACUATION TONE ON ALL horns IN BUILDING AND FLASH ALL STROBES	INITIATE THE AUTOMATIC FIRE MODE CONDITIONS FOR FAN (AC UNIT) OPERATION. PROCEED AC UNIT SHUTDOWN SEQUENCE	INITIATE THE AUTOMATIC FIRE MODE CONDITIONS FOR FIRE SMOKE DAMPER OPERATION. PROCEED FIRE SMOKE DAMPER SHUTDOWN SEQUENCE	RELEASE ALL ELECTRICALLY HELED OPEN FIRE & SMOKE DOORS
		A	B	C	D	E	F	G	H	I	J	K	L	M	N	O	P	Q	
1	MANUAL PULL STATION	●			●	●	●		●								●	●	1
2	WATERFLOW SWITCH	●			●	●	●	●			●				●	●	●	●	2
3	AREA SMOKE DETECTOR	●			●	●	●	●		●					●	●	●	●	3
4	SPRINKLER CONTROL VALVE/TAMPER SWITCH		●		●	●	●					●							4
5	FIRE DRILL KEY SWITCH													●					5
6	FIRE ALARM AC POWER FAILURE			●	●	●	●						●						6
7	FIRE ALARM SYSTEM LOW BATTERY			●	●	●	●						●						7
8	OPEN CIRCUIT			●	●	●	●						●						8
9	GROUND CIRCUIT			●	●	●	●						●						9
10	NOTIFICATION APPLIANCE CIRCUIT SHORT			●	●	●	●						●						10

FIRE ALARM NOTES:

- ALL EQUIPMENT AND WIRING INDICATED ON THESE PLANS IS NEW (U.O.N.).
- PROVIDE WIRING AS REQUIRED BETWEEN ALL DEVICES AND EQUIPMENT AS REQUIRED TO PERFORM FIRE ALARM SYSTEM FUNCTIONS.
- WIRING FOR FIRE ALARM DEVICES IN FINISHED SPACES WITHOUT HUNG CEILING SHALL BE INSTALLED IN EMT CONDUIT.
- ALL STROBES AND HORN/STROBES SHALL BE FLUSH WALL MOUNTED FINISH BY ARCHITECT, APPROVED FOR USE IN NYC.
- ALL DUCT SMOKE DETECTORS INSTALLED IN HUNG CEILING AREA AND IN OUT OF SIGHT AREA SHALL HAVE REMOTELY INSTALLED STATUS INDICATOR LAMPS. COORDINATE EXACT LOCATION WITH ARCHITECT AND GENERAL CONTRACTOR.
- FOR WALL MOUNTED F.A. DEVICES PROVIDE 3/4" CONDUIT TERMINATED IN NEAREST ACCESSIBLE CEILING.
- WIRING FOR FIRE ALARM DEVICES IN UNFINISHED SPACES SHALL BE INSTALLED IN RGS CONDUIT UP TO 8'-0" AFF AND THEN IN EMT CONDUIT ABOVE 8'-0" AFF.
- FOR LOCATIONS AND QUANTITIES OF DEVICES REFER TO FIRE ALARM FLOOR PLANS. WHERE THERE ARE DISCREPANCIES BETWEEN THE PLANS AND THE RISER DIAGRAM, THE GREATER QUANTITY SHALL BE USED.
- CONTRACTOR SHALL VERIFY ALL WIRING WITH FIRE ALARM VENDOR AND OBTAIN WIRING DIAGRAMS BEFORE PROCEEDING WITH THE START OF ANY WORK.
- ALL WIRING SHALL BE IN ACCORDANCE WITH THE NYC ELECTRICAL CODE 760.179(D).
- PROVIDE FAN SHUT DOWN CAPABILITY FOR FANS WITH A RATING LARGER THAN 2,000 CFM. SHUT DOWN SHALL BE ACCOMPLISHED BY ONE OR MORE OUTPUT CONTROL POINTS FROM THE FIRE ALARM SYSTEM TO RELAYS FOR SHUTDOWN. PROVIDE CONTROL AND MONITORING FOR ALL RELAYS. PROVIDE POWER, CONTROL RELAYS, MONITORING AND WIRING FOR ALL FIRES/SMOKE DAMPERS.
- DUCT DETECTORS SHALL BE FURNISHED AND INSTALLED BY THE ELECTRICAL CONTRACTOR ALONG WITH FURNISHING OF THE SAMPLING TUBES. DUCTWORK, MODIFICATIONS AND INSTALLATION OF SAMPLING TUBES SHALL BE BY THE MECHANICAL CONTRACTOR. FOR FANS RATED LARGER THAN 2,000 CFM PROVIDE DUCT DETECTORS IN SUPPLY AND RETURN DUCTWORK.
- PROVIDE ALL REQUIRED EXPANSION PANELS, PC BOARDS, POWER SUPPLIES, BATTERIES, FUSE COUTOUTS AND BRANCH CIRCUITS, ETC, FOR A COMPLETE AND OPERATIONAL FIRE ALARM SYSTEM.
- STROBES AND HORNS SHALL BE WIRED ON ALTERNATING A-B CIRCUITING IN ALL AREAS, AS INDICATED ON THE RISER DIAGRAM.
- CONTRACTOR SHALL PERFORM ALL NYC BUILDING DEPT. FILINGS AND OBTAIN ALL APPROVALS. CONTRACTOR SHALL OBTAIN ALL REQUIRED SIGNED & SEALED NYC BUILDING DEPT. FORMS AND ALL REQUIRED SETS OF DRAWINGS FROM ENGINEER OF RECORD AND BUILDING DEPT. EXPEDITOR.
- UPON COMPLETION OF INSTALLATION THE SYSTEM SHALL BE 100% PRE-TESTED BY THE FIRE ALARM VENDOR AND THE LICENSED ELECTRICAL CONTRACTOR PRIOR TO FDNY INSPECTION.
- CONTRACTOR SHALL SUBMIT TO THE ENGINEER A MARKUP OF FA DRAWINGS INDICATING "AS-BUILT" CONDITIONS FOR ENGINEER'S REFERENCE. IN PREPARING "AS-BUILT" DRAWINGS FOR FILING CONTRACTOR SHALL SIGN "AS-BUILT" STATING A FUNCTIONAL TEST HAS BEEN CONDUCTED OF THE FIRE ALARM SYSTEM AND THE SYSTEM OPERATES AS DESIGNED AND IN ACCORDANCE WITH THE INPUT/OUTPUT PROGRAMMING MATRIX IN ACCORDANCE WITH 3 RCNY & 105-01.

FIRE ALARM SYSTEM RISER DIAGRAM

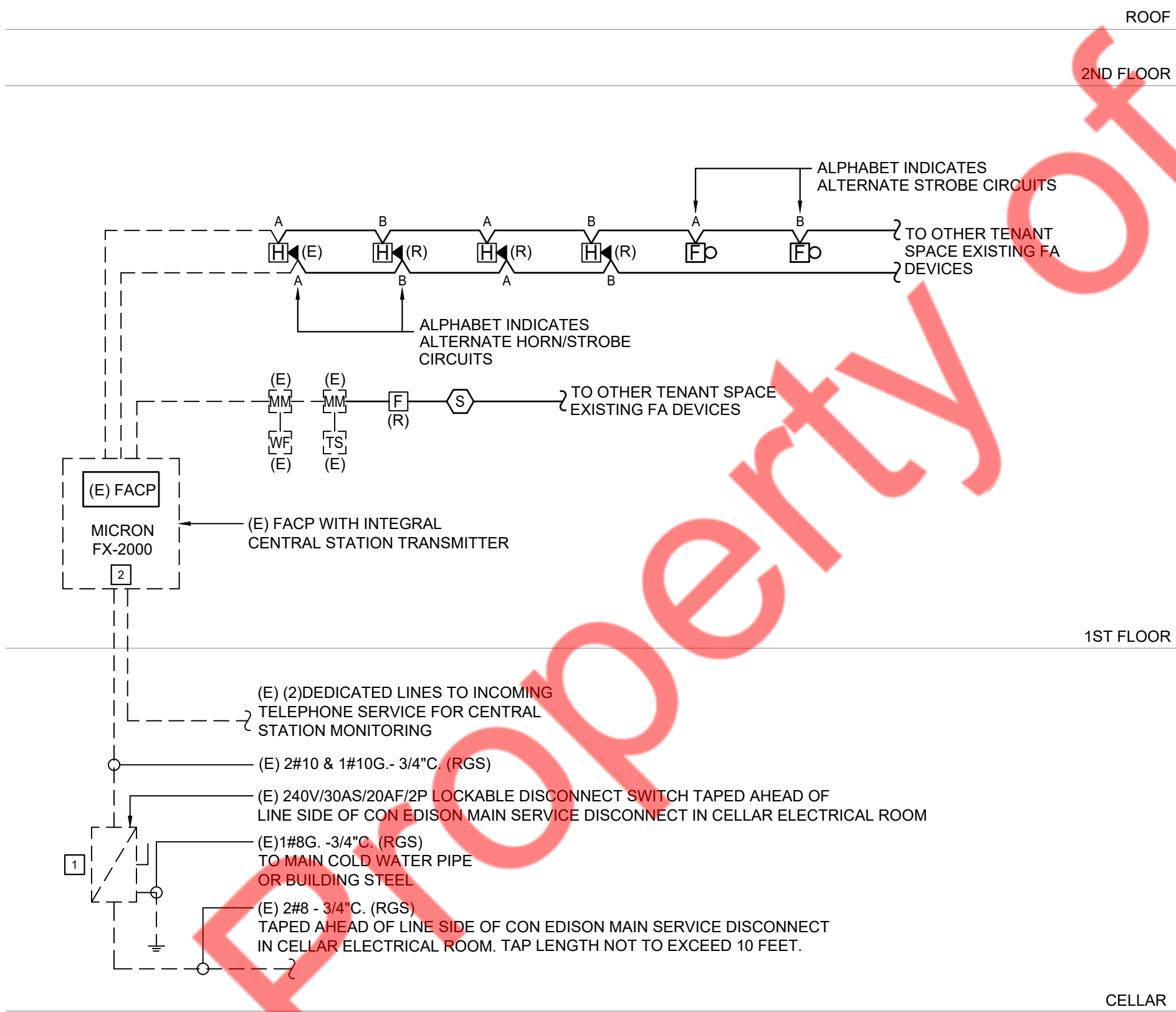

FIRE ALARM RISER NOTES:

- ALL COMPONENTS REQUIRED TO MAKE SYSTEM WORKABLE SHALL BE INCLUDED IN BID PRICE.
- EACH FA RELAY SHALL HAVE MINIMUM OF THREE SETS OF 2 CONTACT 10A RATED @ 120V (TYPICAL).
- ALL DUCT SMOKE DETECTORS INSTALLED IN HUNG CEILING AREA AND IN OUT OF SIGHT AREA SHALL HAVE REMOTELY INSTALLED STATUS INDICATOR LAMPS. COORDINATE EXACT LOCATION WITH ARCHITECT AND GENERAL CONTRACTOR.
- FOR WALL MOUNTED F.A. DEVICES PROVIDE 3/4" CONDUIT TERMINATED IN NEAREST ACCESSIBLE CEILING.
- ALL FIRE ALARM WIRING SHALL BE INSTALLED IN CONDUIT WHERE REQUIRED BY NYC ELECTRICAL CODE 760.131.
- THIS RISER DIAGRAM IS A SCHEMATIC REPRESENTATION OF THE FIRE ALARM SYSTEM. REFER TO FLOOR PLANS FOR EXACT QUANTITY OF DEVICES.
- ALL FIRE ALARM CONDUITS SHALL BE MINIMUM 3/4".
- ALL FIRE ALARM CIRCUITS SHALL BE WIRED NFPA STYLE 4/Y/B (CLASS B) WITH THE EXCEPTION OF THE NETWORK CIRCUIT WHICH SHALL BE NFPA STYLE 7 (CLASS A WITH ISOLATION). DUAL CLASS B NETWORKING IS NOT STYLE 7 AND WILL NOT BE APPROVED.

KEYED WORK NOTES:

- EXACT LOCATION OF EXISTING FUSED DISCONNECT SWITCH (FDS) SHALL BE COORDINATED WITH BUILDING ENGINEER/ARCHITECT.
- EXACT LOCATION OF EXISTING FIRE ALARM CONTROL PANEL (FACP) SHALL BE COORDINATED WITH BUILDING ENGINEER/ARCHITECT. RECONNECT ALL EXISTING RELOCATED AND NEW DEVICES AS REQUIRED.

FIRE ALARM DEVICES TYPICAL MOUNTING HEIGHT:

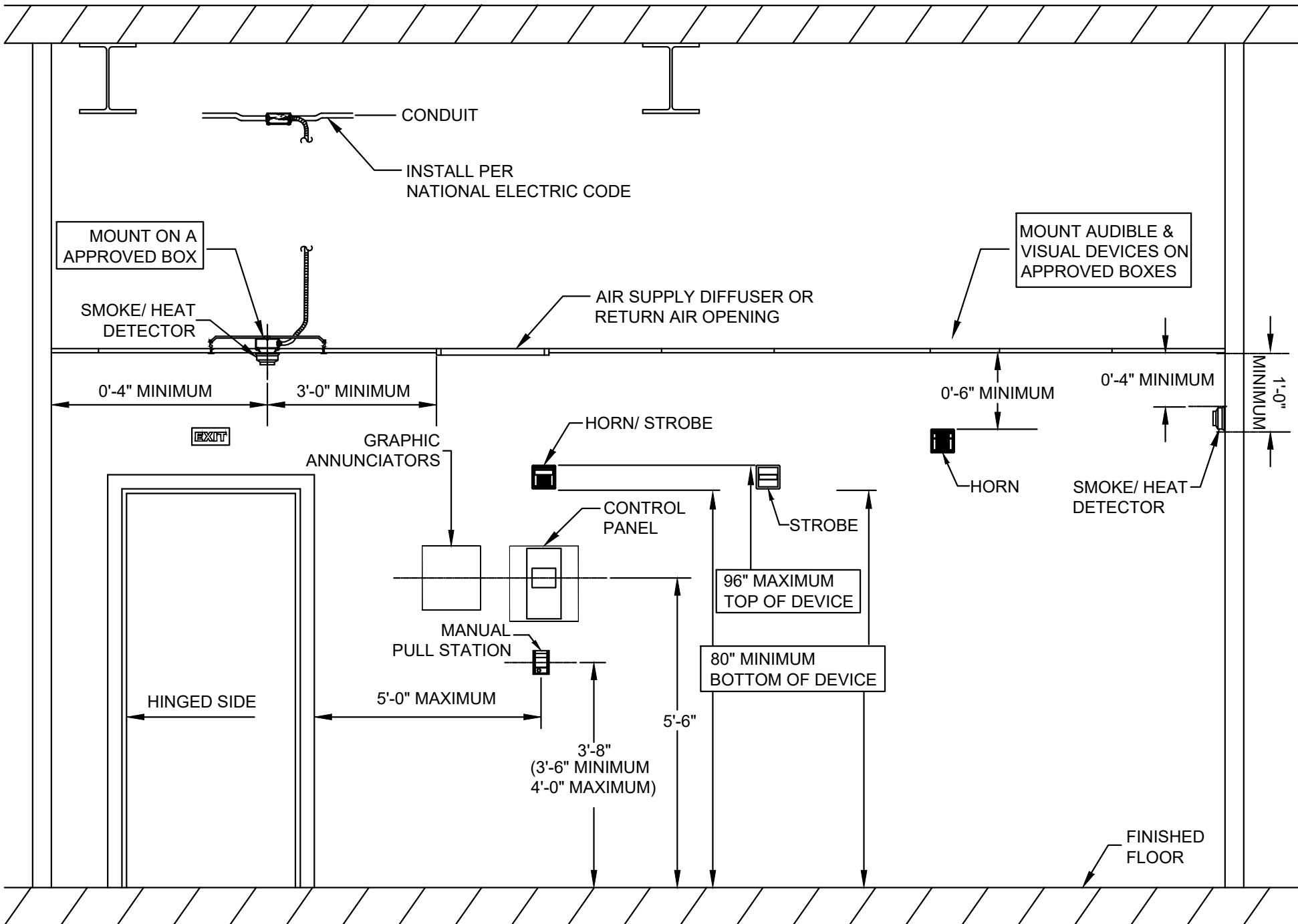

CONSULTANTS

NY ENGINEERS

NEARBY ENGINEERS

382 NE 191ST STREET SUITE 49674,
MIAMI, FL 33179
PH-914.257.3455
WWW.NY-ENGINEERS.COM

ARCHITECT/ENGINEER SEAL:

CONTRACTOR'S NOTES:

WRITTEN DIMENSIONS HOLD PREFERENCE OVER SCALED DIMENSIONS. DO NOT SCALE THE DRAWINGS. THE CONTRACTORS MUST VISIT JOB SITE TO VERIFY ALL EXISTING CONDITIONS AND DIMENSIONS BEFORE SUBMITTING BIDS. REPORT ANY DISCREPANCIES OF ANY CONDITIONS WHICH MAY INTERFERE WITH THE PROPER EXECUTION OF, THE CONTRACT TO THE TENANT'S REPRESENTATIVE. REPORT DISCREPANCIES DURING BIDDING PROCESS AND BEFORE START OF CONSTRUCTION. CHANGE ORDERS NEED TO BE APPROVED BY **GOOD VETS** CONSTRUCTION MANAGER FOR ISSUES ARISING FROM THE FIELD CONDITIONS OR CONFLICTS BETWEEN THE PLANS AND THE EXISTING CONDITIONS PRIOR TO THE COMMENCEMENT OF WORK.

DATE	ISSUE
11.01.24	CLIENT/LL REVIEW SET

DATE	REVISION
------	----------



LOCATION:

PROJECT INFORMATION:

PROJECT NUMBER: 11478-24
DRAWN BY: NYE
REVIEWED BY: NYE
AREA: 3,377 SQ. FT.

TITLE:
FIRE ALARM NOTES,
BUILDING DATA, SYMBOL
LIST & ABBREVIATIONS,
PLOT PLAN, LEGEND, I/O
MATRIX & RISER DIAGRAM
SHEET NUMBER:

FA-001.00

RESERVED FOR DOB:

GENERAL NOTES:

1. REFER TO DWG. FA-001.00 FOR FIRE ALARM NOTES, BUILDING DATA, SYMBOL LIST & ABBREVIATIONS, PLOT PLAN, LEGEND, I/O MATRIX & RISER DIAGRAM
2. FINAL CONDUIT/CABLE ROUTING SHALL BE DETERMINED IN-FIELD, AND PRIOR TO THE COMMENCEMENT OF WORK, COORDINATED WITH OTHER TRADE CONTRACTORS AND THE OWNER.
3. FIRE ALARM CONTRACTOR SHALL COORDINATE ALL THE FIRE ALARM DEVICE LOCATION WITH THE REFLECTED CEILING PLAN AND CONFIRM IN THE FIELD WITH ARCHITECT/OWNER.
4. ALL DEVICES SHALL BE COMPATIBLE WITH AND MAINTAIN THE UL LISTING OF EXISTING FIRE ALARM SYSTEM.
5. FIRE ALARM CONTRACTOR SHALL FIELD VERIFY EXACT REQUIREMENTS FOR FIRE ALARM SYSTEM PRIOR TO BID. REUSE EXISTING FA DEVICES BY RELOCATING TO NEW LOCATION, SUPPLY AND INSTALL ALL NEW NECESSARY EQUIPMENT AS REQUIRED.
6. CONFIRM REQUIRED DEVICES AND SEQUENCE OF OPERATION WITH FIRE G.C./OWNER.

KEYED NOTES: #

- 1 EXISTING FIRE ALARM PANEL TO REMAIN. FIRE ALARM CONTRACTOR SHALL COORDINATE WITH BASE BUILDING FOR THE EXACT LOCATION OF THE EXISTING EQUIPMENT. BASE BID ACCORDINGLY.
- 2 FIRE ALARM CONTRACTOR SHALL COORDINATE THE EXACT LOCATION OF EXISTING TAMPER AND WATER FLOW SWITCHES IN FIELD ASSOCIATED TO PROJECT SPACE. COORDINATE THE EXACT QUANTITY OF TAMPER AND WATER FLOW SWITCHES WITH SPRINKLER CONTRACTOR IN FIELD. BASE BID ACCORDINGLY.
- 3 FIRE ALARM CONTRACTOR SHALL FIELD VERIFY AND REUSE EXISTING FA DEVICES BY RELOCATING TO NEW LOCATION AS SHOWN IF POSSIBLE, OTHERWISE PROVIDE NEW. BASE BID ACCORDINGLY.
- 4 THE FIRE ALARM CONTRACTOR SHALL COORDINATE THE EXACT LOCATION OF HVAC EQUIPMENT ASSOCIATED TO PROJECT SPACE WITH THE MECHANICAL CONTRACTOR IN THE FIELD. PROVIDE A DUCT DETECTOR IF REQUIRED, AND PROVIDE CONNECTION TO NEW DEVICES FROM THE EXISTING FIRE ALARM PANEL AS NEEDED.

ABBREVIATIONS:

(R) - RELOCATED EXISTING DEVICE
(E) - EXISTING TO REMAIN

KEYPLAN:

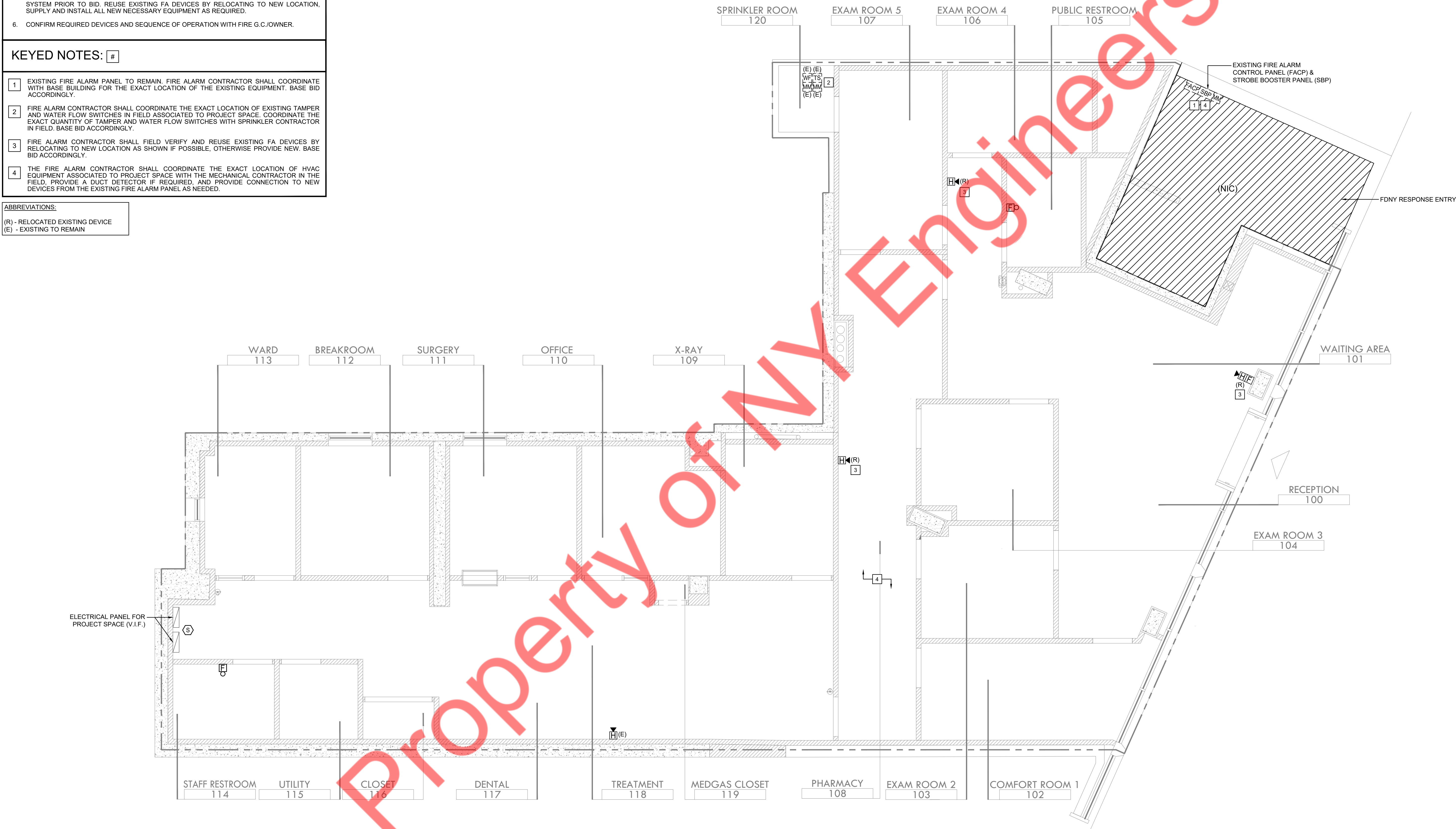
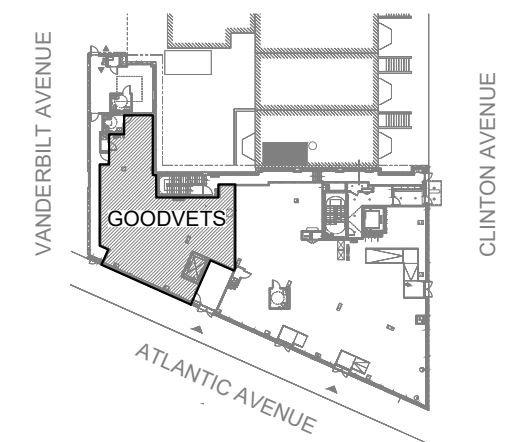

CONSULTANTS

NY ENGINEERS

NEARBY ENGINEERS

382 NE 191ST STREET SUITE 49674,
MIAMI, FL 33179
PH-914.257.3455
WWW.NY-ENGINEERS.COM

ARCHITECT/ENGINEER SEAL:

CONTRACTOR'S NOTES:

WRITTEN DIMENSIONS HOLD PREFERENCE OVER SCALED DIMENSIONS. DO NOT SCALE THE DRAWINGS. THE CONTRACTORS MUST VISIT JOB SITE TO VERIFY ALL EXISTING CONDITIONS AND DIMENSIONS BEFORE SUBMITTING BIDS. REPORT ANY DISCREPANCIES OF ANY CONDITIONS WHICH MAY INTERFERE WITH THE PROPER EXECUTION OF THE CONTRACT TO THE TENANT'S REPRESENTATIVE. REPORT DISCREPANCIES DURING BIDDING PROCESS AND BEFORE START OF CONSTRUCTION. CHANGE ORDERS NEED TO BE APPROVED BY **GOOD VETS** CONSTRUCTION MANAGER FOR ISSUES ARISING FROM THE FIELD CONDITIONS OR CONFLICTS BETWEEN THE PLANS AND THE EXISTING CONDITIONS PRIOR TO THE COMMENCEMENT OF WORK.

DATE	ISSUE
11.01.24	CLIENT/LL REVIEW SET

DATE	REVISION
------	----------



LOCATION:

PROJECT INFORMATION:

PROJECT NUMBER: 11478-24
DRAWN BY: NYE
REVIEWED BY: NYE
AREA: 3,377 SQ. FT.

TITLE:

1ST FLOOR FIRE ALARM PLAN

SHEET NUMBER:

FA-100.00

RESERVED FOR DOB:

GENERAL NOTES:

- ALL SPRINKLER WORK SHALL BE IN ACCORDANCE WITH THE REQUIREMENTS OF N.F.P.A.-13 AND ALL LOCAL AUTHORITIES.
- CONTRACTOR SHALL FIELD VERIFY EXACT ELEVATION, LOCATION AND PIPE SIZES OF EXISTING SPRINKLER HEADS AND PIPING BEFORE INSTALLATION OF NEW WORK. CONTRACTOR SHALL COORDINATE WITH OTHER TRADES AND SHALL INSTALL NEW WORK TO CLEAR DUCTWORK AND LIGHTING FIXTURES.
- ALL SPRINKLER WORK SHALL COMPLY WITH BUILDING STANDARDS AND REQUIREMENTS.
- ALL SPRINKLER HEADS SHALL BE INSTALLED AT CENTER OF TILE IF CEILING IS PROVIDED.
- GENERAL CONTRACTOR SHALL COORDINATE FINAL FURNITURE/EQUIPMENT HEIGHT ELEVATIONS AND LOCATIONS WITH SPRINKLER INSTALLATION. ENGINEER SHALL BE NOTIFIED WHEN FURNITURE/EQUIPMENT IS LESS THAN 18" TO UNDERSIDE OF CEILING.
- THE SPRINKLER SYSTEMS ARE TO BE HYDROSTATIC TESTED FOR A (1) HOUR MINIMUM AT 200 LBS AS PER NYC APPENDIX Q. PRESSURE AND ARE TO BE WITNESSED BY AUTHORIZED BUILDING PERSONNEL. COORDINATE ALL TESTING WITH BUILDING MANAGER.
- PIPES SIZES SHOWN ARE BASED ON DESIGN PIPING LAYOUTS ONLY. ACTUAL PIPE SIZES SHALL BE DETERMINED BY CONTRACTORS HYDRAULIC CALCULATIONS BASED ON HIS INSTALLATION DRAWINGS. CONTRACTOR SHALL ALLOW FOR THIS AND INCLUDE THIS IN HIS CONTRACT PRICE.
- DRAWING INDICATES SPRINKLER SYSTEM DESIGN ONLY. CONTRACTOR RESPONSIBLE FOR OFFSETS, DROPS AND RISES FOR COORDINATION WITH OTHER TRADES.
- G.C. SHALL COORDINATE AND ARRANGE FOR DRAINING AND DEACTIVATION OF EXISTING SPRINKLER SYSTEM WITH BUILDING MANAGEMENT AS REQUIRED.
- G.C. SHALL BE RESPONSIBLE FOR ALL FINAL TESTS AND INSPECTIONS OF COMPLETED WORK REQUIRED BY THE BUILDING MANAGEMENT PRIOR TO OCCUPANCY OF SPACE.
- ALL SPRINKLER WORK SHALL BE TESTED AND MADE OPERATIONAL PRIOR TO CARPET AND FURNITURE INSTALLATION. G.C. SHALL REPAIR AND/OR REPLACE ALL FINISHES DAMAGED BY DEFECTIVE SPRINKLER WORK AT HIS EXPENSE.
- G.C. SHALL PROPERLY TEST AND INSPECT EXISTING SPRINKLER SYSTEM PRIOR TO COMMENCEMENT OF WORK AND SHALL NOTIFY BUILDING MANAGEMENT IMMEDIATELY IF REPAIR OF EXISTING SPRINKLER SYSTEM IS REQUIRED.
- ALL BURNING, CUTTING, SOLDERING AND WELDING SHALL BE COORDINATED WITH BUILDING FIRE SYSTEMS WITH BUILDING MANAGEMENT, AS REQUIRED.
- G.C. SHALL COORDINATE ARRANGEMENTS FOR TEMPORARY DISCONNECT AND RECONNECT WITH MANAGEMENT PRIOR TO COMMENCEMENT OF WORK.
- G.C. SHALL BE RESPONSIBLE FOR OBTAINING PERMITS AND APPROVALS REQUIRED BY BUILDING INSPECTOR AND FIRE MARSHALL IN CONJUNCTION WITH CHANGES TO EXISTING SPRINKLER SYSTEM.
- REFER TO ENGINEERING DRAWINGS FOR SPRINKLER HEADS, LIGHT SENSORS AND FIRE DETECTION DEVICES.
- ALL SERVICE SHUTDOWNS SHALL BE BY BASE BUILDING ENGINEERS. MINIMUM OF 48 HOURS NOTICE IS REQUIRED TO THE BUILDING OFFICE PRIOR TO SHUT DOWN.
- ALL WORK TO BE DONE DURING THE HOURS DESIGNATED BY OWNER.
- UPON COMPLETION OF ALL SPRINKLER WORK, CONTRACTOR SHALL TEST AND INSPECT ENTIRE SPRINKLER SYSTEM. ENTIRE SYSTEM SHALL BE FULLY OPERATIONAL AND APPROVED IN COMPLIANCE WITH ALL AHJ.
- UPON SUCCESSFUL COMPLETION OF ALL TESTING, CONTRACTOR SHALL PRIME AND PAINT ALL EXPOSED SPRINKLER PIPING. COLOR AND FINISH SHALL BE AS PER ARCHITECT.
- CONTRACTOR SHALL INCLUDE IN HIS BID THE COST TO PROVIDE (5) FIVE ADDITIONAL SPRINKLERS INSTALLED. EXACT LOCATIONS OF THESE SPRINKLER HEADS SHALL BE DETERMINED IN FIELD.
- CONTRACTOR SHALL COORDINATE WITH OTHER TRADES AND SHALL INSTALL NEW WORK TO CLEAR DUCTWORK AND LIGHTING FIXTURES.
- ALL SPRINKLER WORK SHALL COMPLY WITH BUILDING STANDARDS AND REQUIREMENTS.
- DRAWING INDICATES SPRINKLER SYSTEM DESIGN ONLY. CONTRACTOR RESPONSIBLE FOR OFFSETS, DROPS AND RISES FOR COORDINATION WITH OTHER TRADES.
- PIPES SIZES SHOWN ARE BASED ON SCHEDULE OF PIPE SIZE PIPING LAYOUTS ONLY. ACTUAL PIPE SIZES SHALL BE DETERMINED BY CONTRACTORS HYDRAULIC CALCULATIONS BASED ON HIS INSTALLATION DRAWINGS. CONTRACTOR SHALL ALLOW FOR THIS AND INCLUDE THIS IN HIS CONTRACT PRICE.
- PROVIDE AUXILIARY DRAINS AT TRAPPED SECTIONS OF PIPING AS REQUIRED BY NFPA-13.
- GENERAL CONTRACTOR SHALL COORDINATE FINAL FURNITURE/EQUIPMENT HEIGHT ELEVATIONS AND LOCATIONS WITH SPRINKLER INSTALLATION. ENGINEER SHALL BE NOTIFIED WHEN FURNITURE/EQUIPMENT IS LESS THAN 18" TO UNDERSIDE OF CEILING PRIOR TO INSTALLATION.
- COMPOSITE DRAWINGS
CONTRACTOR SHALL BE GIVEN A SEPIA TRANSPARENCIES TO IMPOSE THEIR WORK FOR A COORDINATED ALLOCATION OF SPACE. PROCEDURE SHALL INCLUDE HVAC CONTRACTOR TO INDICATE DUCT WORK, PIPING, STRUCTURAL AND ARCHITECTURAL DETAILS. SEPIAS SHALL BE GIVEN TO PLUMBING, SPRINKLER AND ELECTRICAL TRADES WHO WILL DRAW HIS WORK ON DRAWINGS. HVAC CONTRACTORS SHALL HOLD A COORDINATION MEETING WITH ALL CONTRACTORS TO ELIMINATE INTERFERENCE OR CONFLICTS IN INSTALLING WORK. IF UNABLE TO EACH AGREEMENT ISSUE, ARCHITECT SHALL MAKE BINDING DECISION.
- CONTRACTOR SHALL COORDINATE SPRINKLER MAIN AND BRANCHES WITH NEW CONSTRUCTION TO AVOID CONFLICTS WITH CEILING HEIGHTS, DUCTWORK, LIGHTING FIXTURES, BEAMS, CONTRACTOR TO ADJUST PIPING ACCORDINGLY TO ACCOMMODATE NEW CONSTRUCTION.

BUILDING DEPARTMENT SPRINKLER NOTES

- THE INSTALLATION, COMPONENTS, SIZING, SPACING, CLEARANCES, POSITION AND TYPE OF SYSTEMS SHALL CONFORM TO THE 2022 NEW YORK CITY BUILDING CODE APPENDIX Q, SECTION BCQ102 AND SECTION BC903.
- ONLY APPROVED MATERIALS SHALL BE USED AS PER CHAPTER 6 OF APPENDIX Q, SECTION BCQ102.
- DIRECT CONNECTION OF SPRINKLERS TO THE PUBLIC WATER SYSTEM SHALL CONFORM TO SECTION BCQ102.1
- SPRINKLER SHALL BE PROTECTED AGAINST FREEZING AND INJURY AS PER APPENDIX Q BCQ102.
- INSPECTION AND TESTS OF SPRINKLERS SHALL BE CONDUCTED AS SEC. 901.5 AND APPENDIX Q, SEC. BCQ102, CH. 27 & NEW YORK CITY FIRE CODE.
- THE OCCUPANCY OF THE AREAS TO BE SPRINKLERED IN ACCORDANCE WITH SECTION 5.2 AND A.5.2 OF APPENDIX Q SECTION BCQ102.
- WATER SUPPLY TEST PIPES AND GAUGES SHALL BE PROVIDED AS PER SECTION 8.16.1 AND 8.16.4 OF APPENDIX Q, SECTION BCQ102.
- PIPING, FITTINGS, SPECIFICATIONS, PIPE SCHEDULES, SYSTEM TEST PIPES, PROTECTION AGAINST CORROSION, DAMAGE, VALVES, HANGERS, SPRINKLERS GUARDS AND SHIELDS SHALL BE AS PER APPENDIX Q SECTION BCQ102, CHAPTERS 6 AND 9.
- STOCK OF EXTRA SPRINKLERS WILL BE FURNISHED AS PER SECTION 6.2.9 APPENDIX Q, SECTION BCQ102 (REQUIRED FOR EACH TEMPERATURE RATING).
- SPRINKLER ALARM SHALL BE IN ACCORDANCE WITH SECTION 8.16.1 OF APPENDIX Q, SECTION BCQ102.
- SPACING, LOCATION AND POSITION OF SPRINKLER WILL BE AS PER SECTION 8 OF APPENDIX Q, SECTION BCQ102.
- ALL BLIND SPACES EXCEEDING 6" IN WIDTH OR DEPTH WHICH CONTAIN COMBUSTIBLE MATERIAL WILL BE SPRINKLERED.
- ALL PIPE PASSING THROUGH WALLS WILL COMPLY WITH SECTION BC712.
- THERE IS NO HIGH PILED STORAGE AS DEFINED IN SECTION 3-3.12 OF APPENDIX Q, SECTION BC Q102
- DISTANCE OF SPRINKLERS FROM HEAT SOURCE SHALL BE IN AS PER TABLES 9.3.2.5 (A) AND 8.3.2.5 (B).
- AS PER SECTION BC903.1.2 PROVIDE DEPARTMENT OF WATER SUPPLY LETTER WITH FLOW TEST DATE IF THERE IS A DIRECT CONNECTION TO THE STREET WATER SUPPLY.
- THIS APPLICATION IS NOT FILED AS A RESULT OF ACTION BY THE FIRE COMMISSIONER AS AUTHORIZED BY BS & A TO MODIFY THE CERTIFICATE OF OCCUPANCY NOR IS SUCH ACTION PENDING.
- ALL VALVES SHALL BE IDENTIFIED AS REQUIRED BY SECTION 6.7.4. OF APPENDIX Q, SECTION BCQ102.
- DRAINAGE SHALL CONFORM TO SECTION 8.15.2 OF APPENDIX Q, SECTION BCQ102.
- A ONE PIECE REDUCING FITTING OF GOOD DESIGN SHOULD BE USED WHEREVER A CHANGE IS MADE IN THE SIZE OF PIPE, AS PER SECTION 6.4.6 OF APPENDIX Q, SECTION BCQ102.
- ALL VALVES ON CONNECTIONS TO WATER SUPPLIES TO SPRINKLER SHALL BE APPROVED O.S. & Y. OR APPROVED INDICATOR TYPE.
- DRAIN VALVES AND TEST VALVES SHALL BE APPROVED TYPE AS PER 6.7.3 OF APPENDIX Q, SECTION BCQ102.
- HANGERS SHOULD BE SUPPORTED BY WROUGHT IRON U TYPE OR APPROVED ADJUSTABLE HANGERS. HANGERS SHALL BE OF THE TYPE APPROVED FOR USE WITH THE PIPE OR TUBE INVOLVED, AS PER CHAPTER 9, OF APPENDIX Q, SECTION BCQ102.
- PROVISIONS SHOULD BE MADE TO FACILITATE FLUSHING SYSTEM PIPING BY PROVIDING FLUSHING CONNECTIONS CONSISTING OF A CAPPED NIPPLE 4" LONG ON END OF A CROSS MAIN AS PER SECTION 8.14.16 OF APPENDIX Q, SECTION BCQ102.
- SPRINKLER SHALL BE AN APPROVED TYPE AS PER SECTION 8.3 OF APPENDIX Q, SECTION BCQ102.
- TEMPERATURE RATING SHALL COMPLY WITH SECTION 8.3.2 OF APPENDIX Q, SECTION BCQ102.
- 18" MINIMUM CLEARANCE TO BELOW SPRINKLER DEFLECTOR AS PER SECTION 8.5.6. OF APPENDIX Q, SECTION BCQ102.
- SPACING AND LOCATION OF SPRINKLERS SHALL COMPLY WITH CHAPTER 8 OF APPENDIX Q, SECTION BCQ102.
- SPRINKLER SYSTEM COMPLIES WITH 13-2016 AS MODIFIED BY APPENDIX Q, SECTION BCQ102.
- SOURCES OF WATER SUPPLY FOR SPRINKLER SYSTEMS AS PER CHAPTER 15 OF APPENDIX Q, SECTION BCQ102.
- PIPE SCHEDULE SYSTEMS SHALL BE IN ACCORDANCE WITH SECTION 14.5 OF APPENDIX Q, SECTION BCQ102.
- HYDRAULICALLY DESIGNED SYSTEMS SHALL BE IN ACCORDANCE WITH CHAPTER 11 OF APPENDIX Q, SECTION BCQ102.
- MINIMUM BRANCH PIPE SIZE TO BE ONE INCH (1").
- THIS APPLICATION IS MADE ONLY FOR WORK INDICATED ON THE SPECIFICATION SHEET. ALL OTHER MATTERS SHOWN ARE NOT TO BE RELIED UPON OR TO BE CONSIDERED AS EITHER BEING APPROVED OR IN ACCORDANCE WITH APPLICABLE CODES.
- PAINTING FOR DEDICATED SPRINKLER PIPING AND VALVES HANDLES SHOULD BE AS PER NYC BC SECTION 903.6.

SPACING BETWEEN SPRINKLER HEADS

LIGHT HAZARD: 15' MAX. & 6' MIN.

NOTE: MAXIMUM DISTANCE BETWEEN SPRINKLER HEADS & WALLS IS ½ THE DISTANCE BETWEEN HEADS.

PROTECTION AREA OF SPRINKLER HEADS

LIGHT HAZARD: 225 SQ.FT.

SCOPE OF WORK:

- FOR AUTOMATIC SPRINKLER WORK.THE SPRINKLER SYSTEM IS DESIGNED AS PER NFPA 13 , AS MODIFIED BY NYC BC APPENDIX Q.
- SCOPE IS FOR 1ST FLOOR GOODVETS FITOUT SPACE.

DESIGN CRITERIA SUMMARY

PROJECT DESIGNED BY PIPE SCHEDULE AS PER 2016 NFPA-13 11.2.2.3.

GENERAL NOTES:

- FOR SPRINKLER WORK ONLY.
- ALL SPRINKLER HEADS MEET DESIGN CRITERIA PER COVERAGE.
- PROVIDE FREEZE PROTECTION FOR ALL SPRINKLER PIPING AND EQUIPMENTS SUBJECT TO TEMPERATURE BELOW 40 DEGREE F.

SPECIAL INSPECTION SPRINKLER NOTE:

- SPECIAL INSPECTION OF SPRINKLER SYSTEM TO BE PERFORMED IN ACCORDANCE WITH NY CITY BUILDING CODE SECTION BC 1705-29
- FIRE RESISTANT PENETRATION & JOINTS IN ACCORDANCE WITH NY CITY BUILDING CODE BC-1705.17
- POST INSTALLATION ANCHOR INSPECTION TO BE DONE IN ACCORDANCE WITH NY CITY BUILDING CODE BC-1705.37

PROGRESS INSPECTION SPRINKLER NOTE

- ENERGY CODE COMPLIANCE - THIS SHOULD BE INDICATED ON THE ENERGY ANALYSIS CHART THAT THE IS AN EXEMPT WORK TYPE UNDER NYCECC 2020

ECC NOTES

2020 NYCECC COMPLIANCE; NEW YORK CITY CONSERVATION CODE.

TO THE BEST OF MY KNOWLEDGE, BELIEF AND PROFESSIONAL JUDGMENT, ALL WORK UNDER THIS APPLICATION IS EXEMPT FROM THE NYCECC IN ACCORDANCE WITH ONE OF THE FOLLOWING: FA, FP, SD, SP, FS, EQ, CC, OT/BPP, OT/FPP

KEY PLAN:

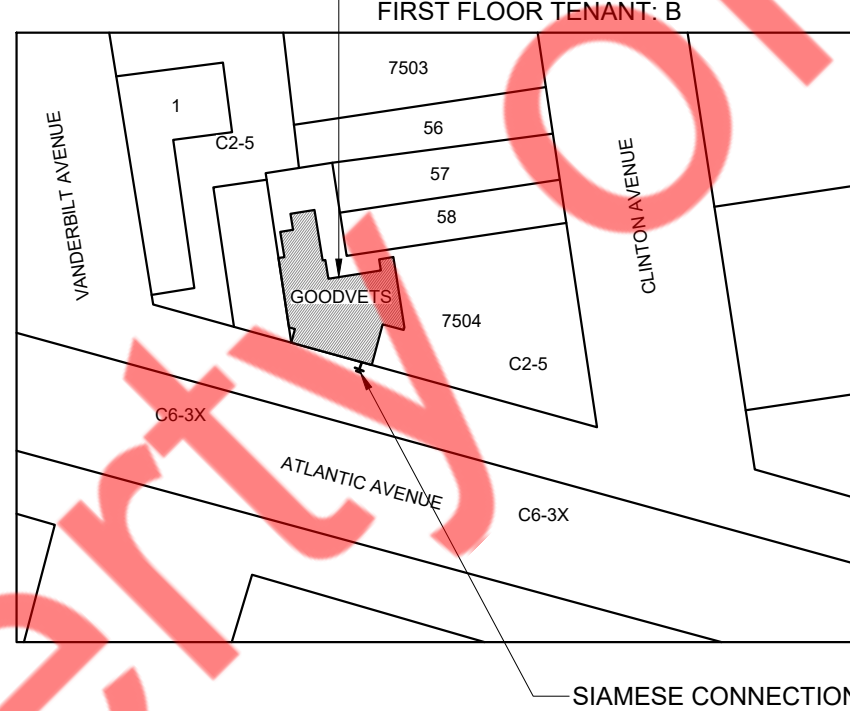

544 CLINTON AVENUE, BROOKLYN, NY 11238

- BLOCK : 2010
- LOT: 59
- ZONING: C2-5
- MAP: 16c
- OCC. CLASS : B
- CONST. CLASS: I-B
- BLDG. HEIGHT: 51
- BLDG. STY: 04

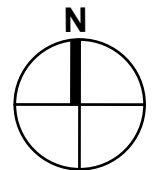

PLOT PLAN
N.T.S.

SPRINKLER DRAWING LIST

01	SP-001.00	SPRINKLER SYMBOLS, ABBREVIATIONS, NOTES & PLOT PLAN
02	SP-002.00	SPRINKLER SPECIFICATIONS & SCHEDULES
03	SP-101.00	FIRST FLOOR SPRINKLER PLAN
04	SP-501.00	SPRINKLER DETAILS

SPRINKLER LEGEND

- (RE) (N) DISCONNECT AND REMOVE EXISTING UPRIGHT SPRINKLER HEAD WITH BRANCH PIPING AND CAP. CONNECT NEW CONCEALED SPRINKLER HEAD WITH BRANCH PIPING AND EXTEND TO NEW LOCATION AS SHOWN ON FLOOR PLAN.
- (N) NEW CONCEALED SPRINKLER HEAD
- SP — NEW SPRINKLER PIPING
- EX. SP — EXISTING SPRINKLER PIPING TO REMAIN
- POINT OF CONNECTION

HAZARD CLASSIFICATION AND DESIGN DENSITY:

AREA: ALL

OCCUPANCY: LIGHT HAZARD

MINIMUM DESIGN DENSITY: 0.10 GPM/SQ. FT

ABBREVIATIONS:

- (RE) - EXISTING SPRINKLER HEAD TO BE RELOCATED
- (N) - NEW SPRINKLER HEAD
- (R) - EXISTING SPRINKLER HEAD TO BE REMOVED

SPRINKLER RISER DIAGRAM

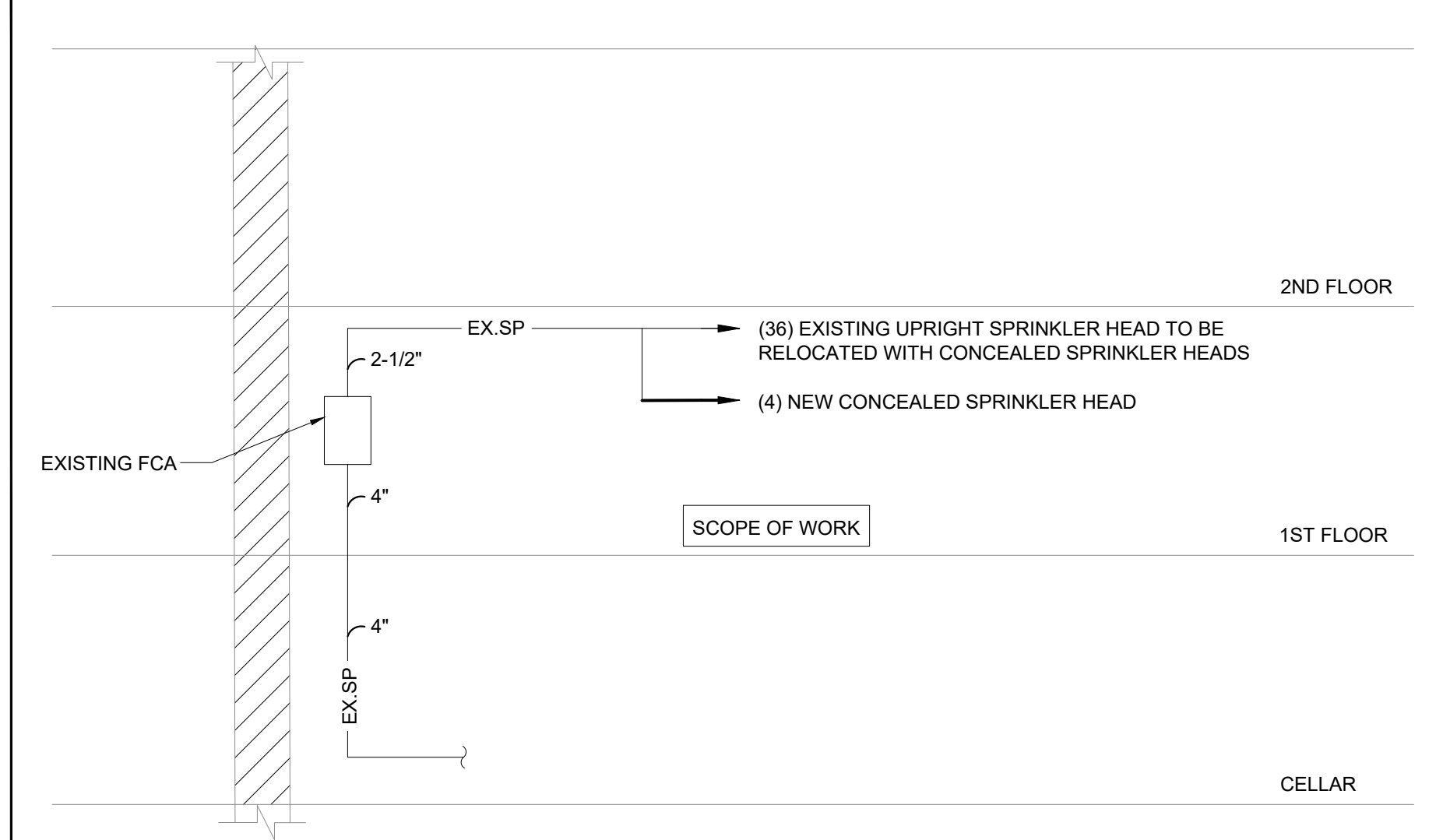

CONSULTANTS

NY ENGINEERS

NEARBY ENGINEERS

382 NE 191ST STREET SUITE 49674,
MIAMI, FL 33179
PH-914.257.3455
WWW.NY-ENGINEERS.COM

ARCHITECT/ENGINEER SEAL:

CONTRACTOR'S NOTES:

WRITTEN DIMENSIONS HOLD PREFERENCE OVER SCALED DIMENSIONS. DO NOT SCALE THE DRAWINGS. THE CONTRACTORS MUST VISIT JOB SITE TO VERIFY ALL EXISTING CONDITIONS AND DIMENSIONS BEFORE SUBMITTING BIDS. REPORT ANY DISCREPANCIES OF ANY CONDITIONS WHICH MAY INTERFERE WITH THE PROPER EXECUTION OF THE CONTRACT TO THE TENANT'S REPRESENTATIVE. REPORT DISCREPANCIES DURING BIDDING PROCESS AND BEFORE START OF CONSTRUCTION. CHANGE ORDERS NEED TO BE APPROVED BY **GOOD VETS** CONSTRUCTION MANAGER FOR ISSUES ARISING FROM THE FIELD CONDITIONS OR CONFLICTS BETWEEN THE PLANS AND THE EXISTING CONDITIONS PRIOR TO THE COMMENCEMENT OF WORK.

DATE	ISSUE
11.01.24	CLIENT/LL REVIEW SET

DATE	REVISION
------	----------



GoodVets

LOCATION:

PROJECT INFORMATION:

PROJECT NUMBER: 11478-24
DRAWN BY: NYE
REVIEWED BY: NYE
AREA: 3,377 SQ. FT.

TITLE: **SPRINKLER
NOTES, SYMBOL &
SPECIFICATION**

SHEET NUMBER:

SP-001.00

RESERVED FOR DOB:

GENERAL NOTES:

1. ALL SPRINKLER HEADS & PIPING TO BE COORDINATED WITH EXISTING & NEW SERVICES.
2. CONTRACTOR TO FIELD VERIFY EXACT LOCATION AND SIZE OF EXISTING SYSTEM AND RELOCATE HEADS WHEREVER SHOWN.
3. ALL CONCEALED SPRINKLERS MUST BE SPACED AS FOLLOWS -
 - MAXIMUM 7'5" FROM WALL
 - MAXIMUM DISTANCE BETWEEN 2 SPRINKLER HEADS IS 15'
 - MINIMUM DISTANCE BETWEEN 2 SPRINKLER HEADS IS 6'
 - COVERAGE AREA PER SPRINKLER SHALL BE MAX. 225 SQ.FT.
 - LOT LINE SPRINKLER HEAD MAXIMUM DISTANCE FROM WALL IS 6".
4. ALL SPRINKLER HEADS MEET DESIGN CRITERIA PER COVERAGE.
5. FOR SPRINKLER WORK ONLY.
6. ALL WORK IN OTHER TENANT SPACES/BASE BUILDING SPACES SHALL BE COORDINATED WITH THE LANDLORD FOR ACCESS AND COORDINATED WITH BUILDING STAFF.
7. ALL WORK WITH EXISTING BUILDING RISERS SHALL BE COORDINATED WITH BUILDING STAFF AND ALL TENANTS AFFECTED BY SUCH WORK.
8. COORDINATE ALL SERVICE SHUTDOWNS WITH THE LANDLORD, BUILDING STAFF, AND ALL OTHER TENANTS AFFECTED BY IT.
9. ANY WORK SHOWN ON THE DRAWINGS AND NOT PARTICULARLY DESCRIBED IN THE SPECIFICATIONS OR DETAILS, OR ANY WORK WHICH MAY BE DEEMED NECESSARY TO COMPLETE THE CONTRACT SHALL BE PROVIDED BY THE CONTRACTOR AS PART OF THIS CONTRACT.
10. CONTRACTOR TO CO-ORDINATE ALL SPRINKLER LOCATION WITH LIGHTS, DIFFUSER.
11. CONTRACTOR TO ADJUST EXISTING CONCEALED SPRINKLER HEAD ELEVATION AS PER NEW CEILING HEIGHT.
12. CONTRACTOR TO V.I.F THE CONDITION OF EXISTING SPRINKLER HEAD & PIPING WHICH ARE DAMAGE OR CORRODED NEEDS TO BE REPLACED WITH NEW SPRINKLER HEAD & PIPING. CONTRACTOR HAS TO CONSIDERED ADDITIONAL COST OF NEW SPRINKLER HEADS AND PIPING WHILE BIDDING.
13. ALL BRANCH TAKE-OFF FOR EACH SPRINKLER TO BE MIN. 1".
14. NEWLY ADDED AND RELOCATED SPRINKLER HEAD SHOULD BE COORDINATED WITH LIGHTS, DIFFUSERS.

SPRINKLER HEADS COUNT

SPRINKLER HEADS TYPE	QTY.
NEW CONCEALED SPRINKLER HEAD	04
RELOCATED EXISTING UPRIGHT SPRINKLER HEAD TO NEW CONCEALED HEAD AT NEW LOCATION	36

KEYED NOTES:

- 1 NEW SPRINKLER PIPE CONNECT TO EXISTING SPRINKLER PIPING. CONTRACTOR TO FIELD VERIFY THE EXACT LOCATION & SIZES OF EXISTING SPRINKLER PIPING UPGRADE IF REQUIRED.
- 2 EXISTING SPRINKLER MAIN PIPE TO REMAIN WITH ALL ASSOCIATED EQUIPMENTS, VALVE & ACCESSORIES. CONTRACTOR TO V.I.F THE EXACT LOCATION, SIZE & ROUTINE OF EXISTING SPRINKLER MAIN
- 3 EXISTING FCA ASSEMBLY TO REMAIN WITH ASSOCIATED ACCESSORIES AND FITTINGS.
- 4 CONTRACTOR TO FIELD VERIFY AVAILABILITY OF CEILING PRIOR TO BID. PROVIDE CONCEALED SPRINKLER AS SHOWN ON THE PLAN IF CEILING IS AVAILABLE. BASE BID ACCORDINGLY.
- 5 LOT LINE WINDOW SPRINKLER HEAD SHALL BE 6" TO 12" FROM WINDOW SHIELD.

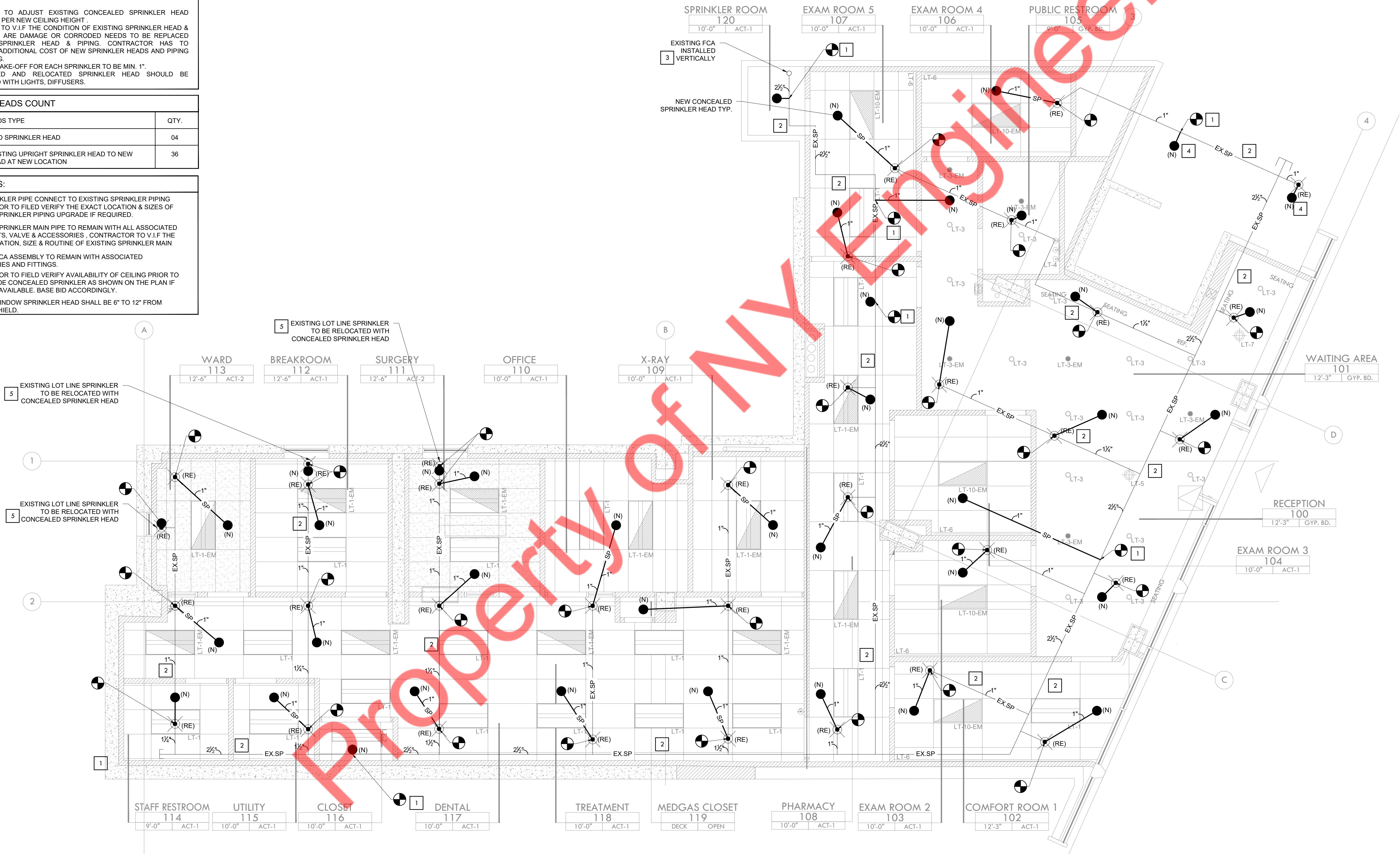

KEYPLAN:

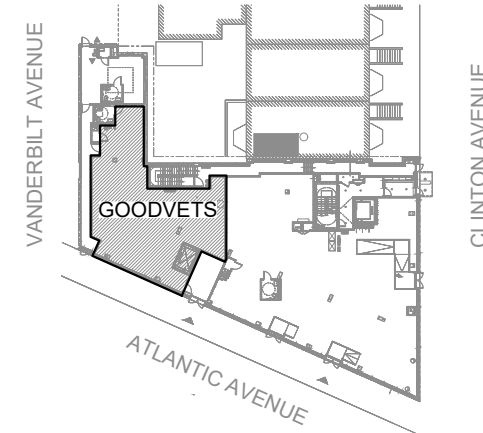

CONSULTANTS

NY ENGINEERS

NEARBY ENGINEERS

382 NE 191ST STREET SUITE 49674,
MIAMI, FL 33179
PH-914.257.3455
WWW.NY-ENGINEERS.COM

ARCHITECT/ENGINEER SEAL:

CONTRACTOR'S NOTES:

WRITTEN DIMENSIONS HOLD PREFERENCE OVER SCALED DIMENSIONS. DO NOT SCALE THE DRAWINGS. THE CONTRACTORS MUST VISIT JOB SITE TO VERIFY ALL EXISTING CONDITIONS AND DIMENSIONS BEFORE SUBMITTING BIDS. REPORT ANY DISCREPANCIES OF ANY CONDITIONS WHICH MAY INTERFERE WITH THE PROPER EXECUTION OF, THE CONTRACT TO THE TENANT'S REPRESENTATIVE. REPORT DISCREPANCIES DURING BIDDING PROCESS AND BEFORE START OF CONSTRUCTION. CHANGE ORDERS NEED TO BE APPROVED BY **GOOD VETS** CONSTRUCTION MANAGER FOR ISSUES ARISING FROM THE FIELD CONDITIONS OR CONFLICTS BETWEEN THE PLANS AND THE EXISTING CONDITIONS PRIOR TO THE COMMENCEMENT OF WORK.

DATE	ISSUE
11.01.24	CLIENT/LL REVIEW SET

DATE	REVISION
------	----------



GoodVets

LOCATION:

PROJECT INFORMATION:

PROJECT NUMBER: 11478-24
DRAWN BY: NYE
REVIEWED BY: NYE
AREA: 3,377 SQ. FT.

TITLE:

**SPRINKLER
FLOOR PLAN**

SHEET NUMBER:

SP-101.00

RESERVED FOR DOB:

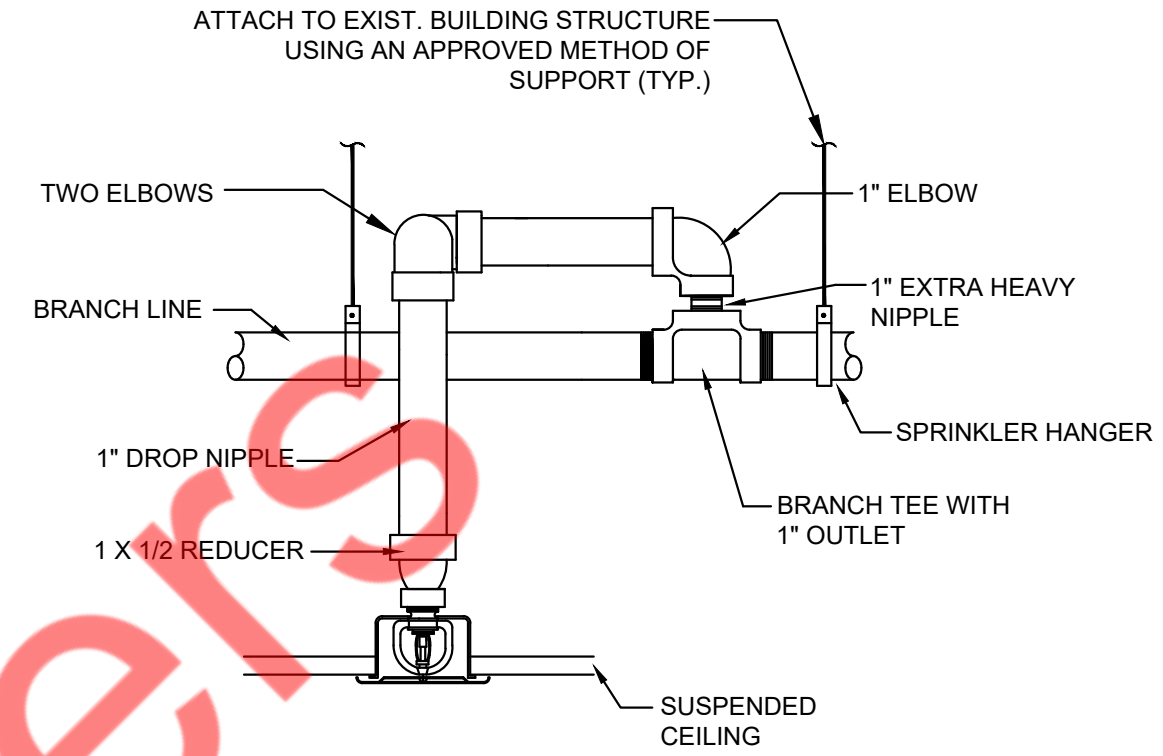
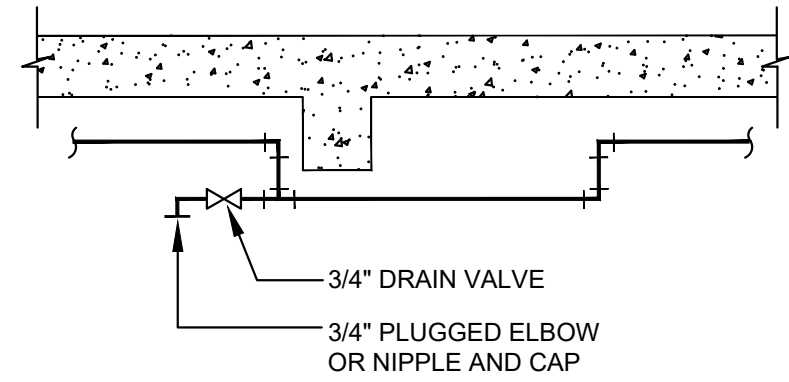
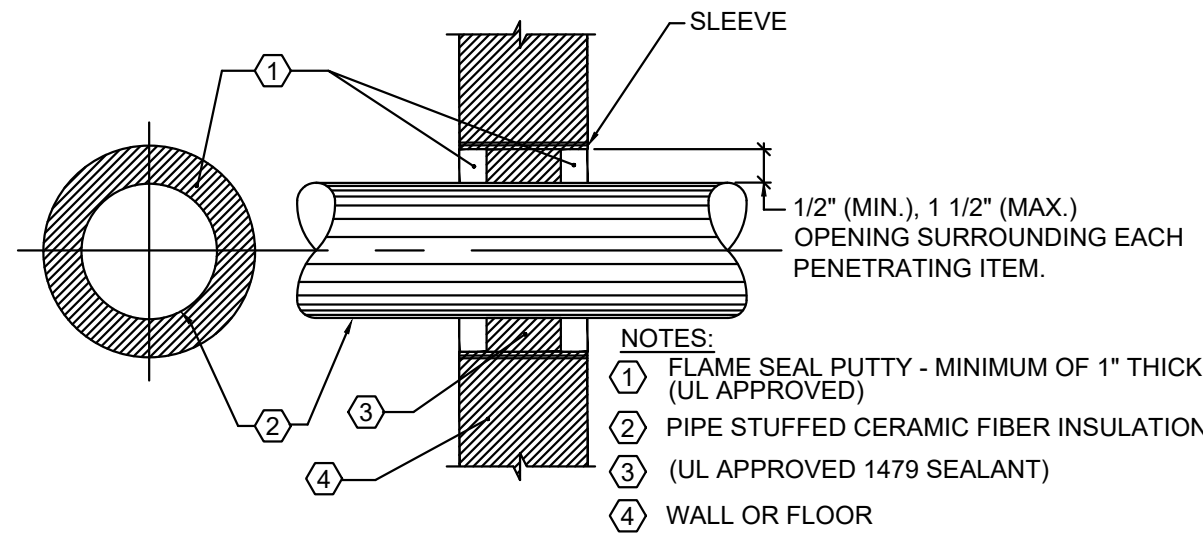

1 SCALE
N.T.S. FIRE STOPPING DETAIL FOR FIRE/ SMOKE RATED WALL/FLOOR OPENINGS

2 SCALE
N.T.S. TYPICAL DRAIN CONNECTION FOR TRAPPED LINES ON WET PIPE SPRINKLER SYSTEMS

3 SCALE
N.T.S. NEW CONCEALED PENDENT SPRINKLER HEAD DETAIL

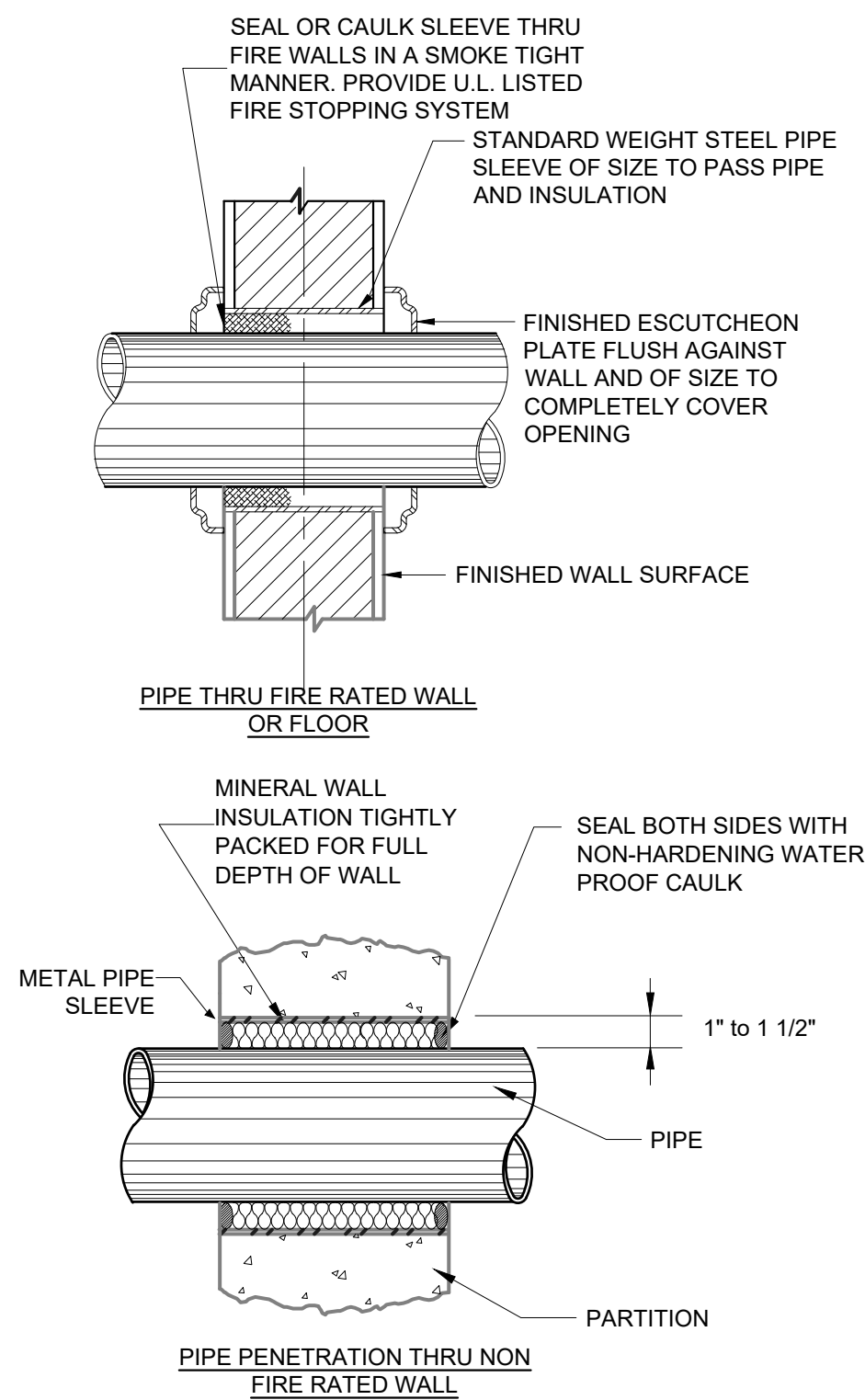

- KEYNOTES:
1. 1" NIPPLE (INLET)
 2. NUT
 3. ADAPTER RING
 4. COLLAR
 5. 304 STAINLESS STEEL FLEXIBLE BRAIDED HOSE (1" NOMINAL DIAMETER) (LENGTHS AVAILABLE 31", 48", 60", & 72")
 6. COLLAR
 7. NUT
 8. REDUCING OUTLET (AVAILABLE 1/2" OR 3/4" FMPT)
 9. CENTER BRACKET ASSEMBLY
 10. SQUARE BAR (AVAILABLE IN 24" AND 48" LENGTHS)
 11. END BRACKET ASSEMBLY
 12. SHEET METAL SCREW
 13. VIC MECHANICAL-T OUTLET STYLE 922 FIRELOCK (1" FMPT) SEE VICTAULIC SUBMITTAL NUMBER 10.85

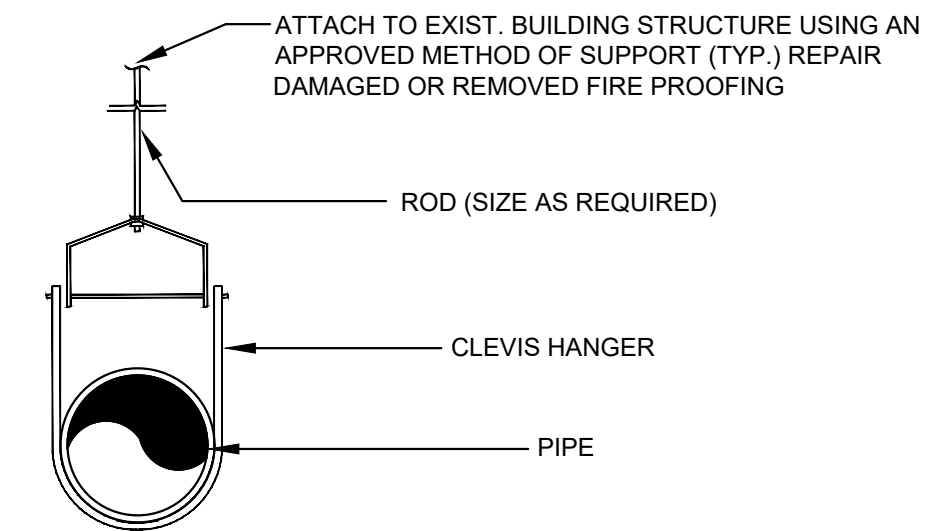
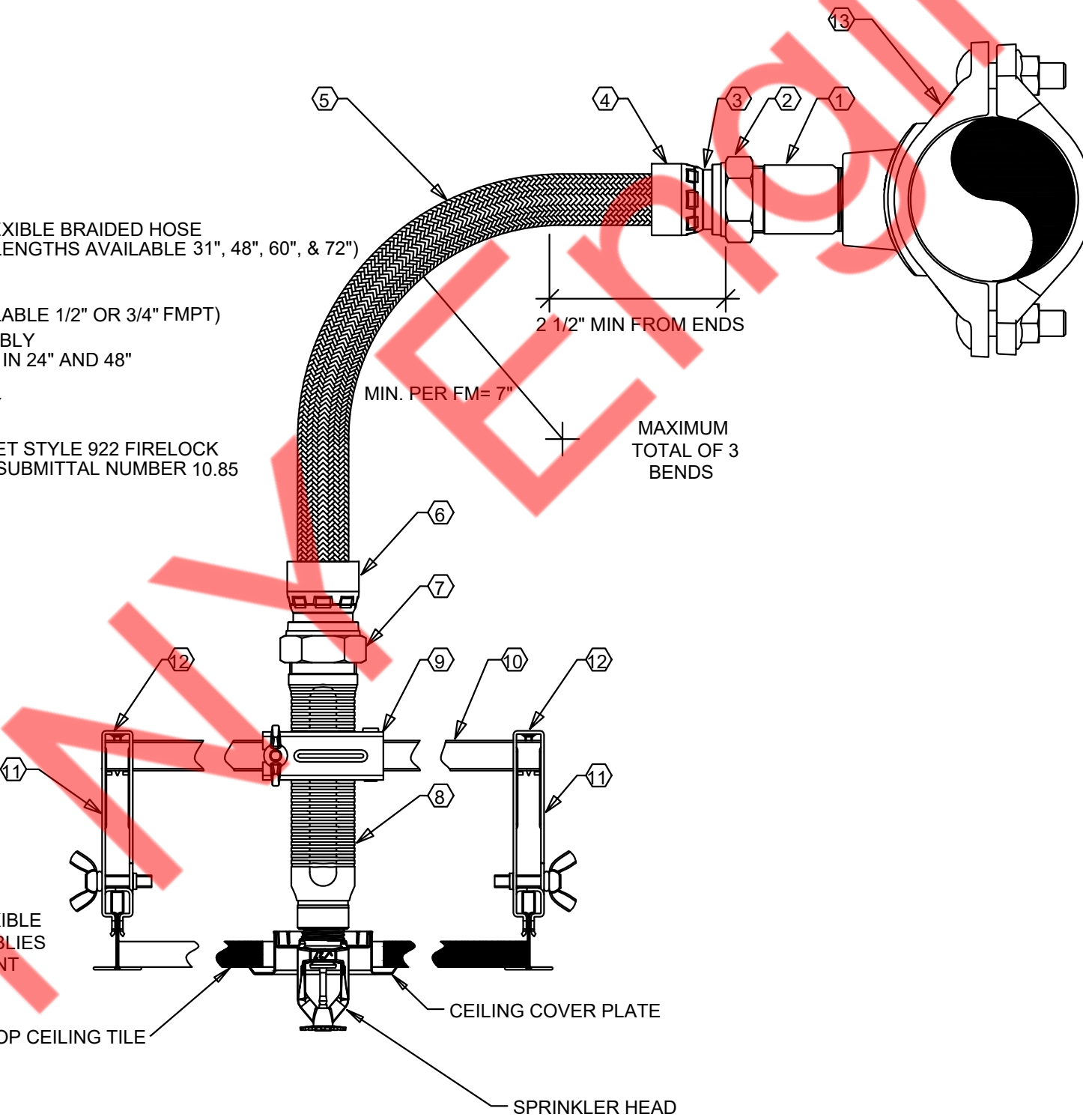

4 SCALE
N.T.S. PIPE SLEEVE THRU WALL SECTION

5 SCALE
N.T.S. FLEXIBLE HOSE CONNECTION DETAIL

6 SCALE
N.T.S. HANGER DETAILS TYPICAL

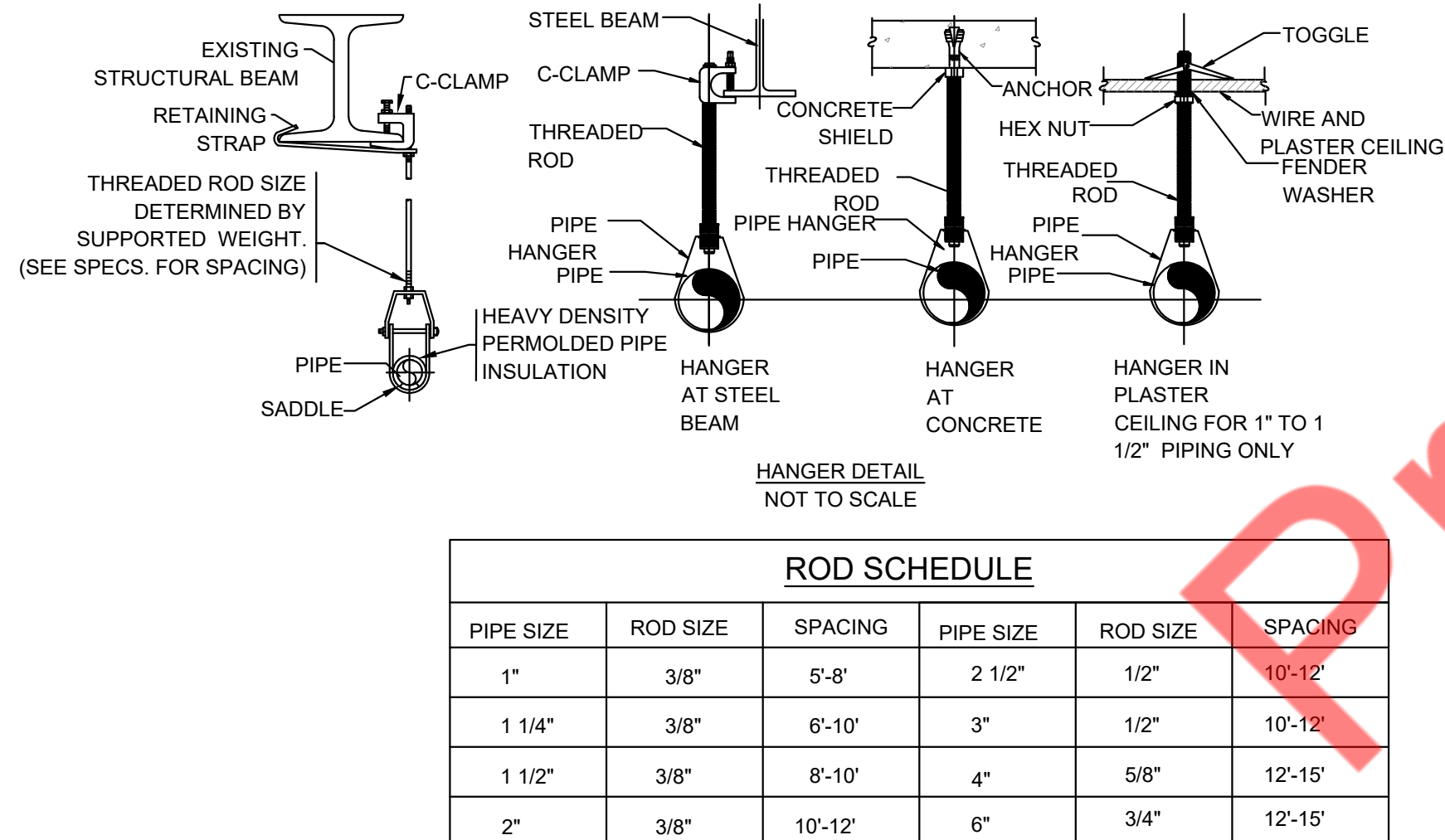

ROD SCHEDULE					
PIPE SIZE	ROD SIZE	SPACING	PIPE SIZE	ROD SIZE	SPACING
1"	3/8"	5'-8"	2 1/2"	1/2"	10'-12"
1 1/4"	3/8"	6'-10"	3"	1/2"	10'-12"
1 1/2"	3/8"	8'-10"	4"	5/8"	12'-15"
2"	3/8"	10'-12"	6"	3/4"	12'-15"

7 SCALE
N.T.S. TYPICAL HANGER DETAIL AND ROD SCHEDULE

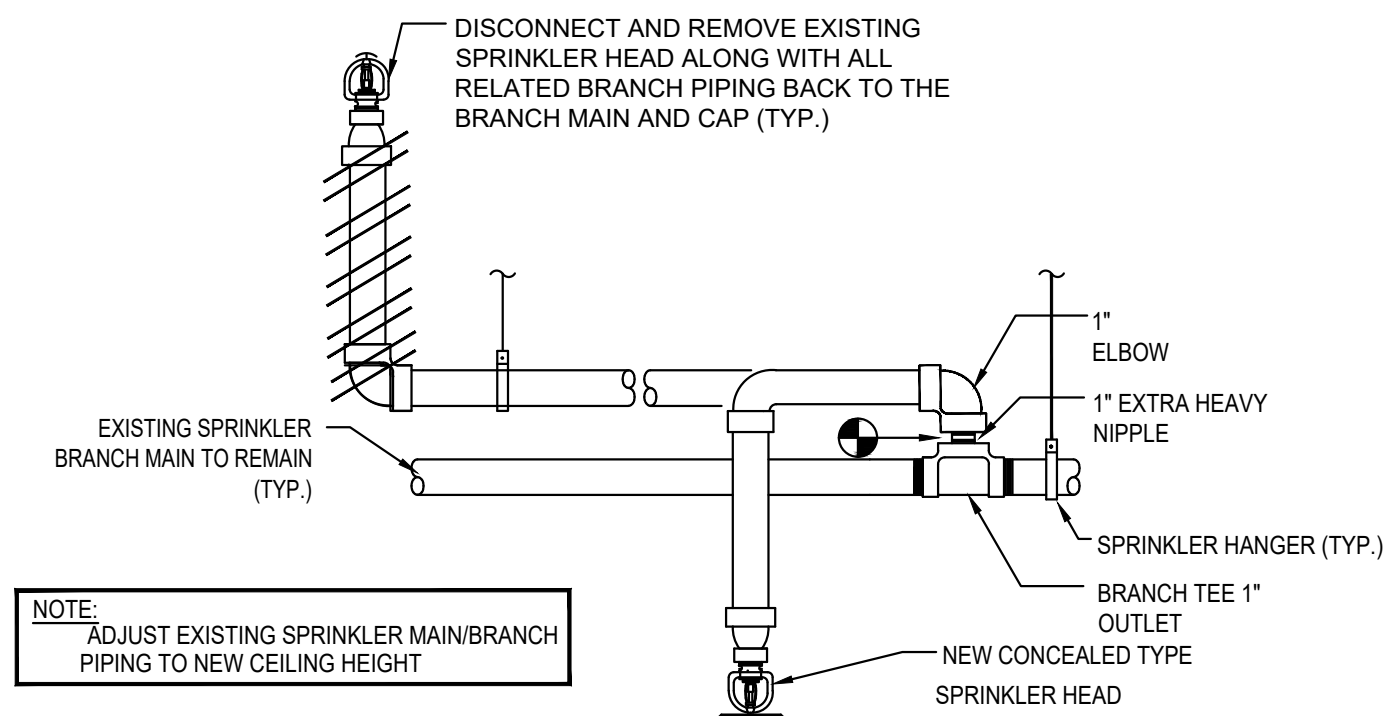

8 SCALE
N.T.S. UPRIGHT SPRINKLER HEAD RELOCATION TO CONCEALED HEAD

1 SCALE
N.T.S. SPRINKLER DETAILS

CONSULTANTS

NY ENGINEERS

NEARBY ENGINEERS

382 NE 191ST STREET SUITE 49674,
MIAMI, FL 33179
PH-914.257.3455
WWW.NY-ENGINEERS.COM

ARCHITECT/ENGINEER SEAL:

CONTRACTOR'S NOTES:

WRITTEN DIMENSIONS HOLD PREFERENCE OVER SCALED DIMENSIONS. DO NOT SCALE THE DRAWINGS. THE CONTRACTORS MUST VISIT JOB SITE TO VERIFY ALL EXISTING CONDITIONS AND DIMENSIONS BEFORE SUBMITTING BIDS. REPORT ANY DISCREPANCIES OF ANY CONDITIONS WHICH MAY INTERFERE WITH THE PROPER EXECUTION OF THE CONTRACT TO THE TENANT'S REPRESENTATIVE. REPORT DISCREPANCIES DURING BIDDING PROCESS AND BEFORE START OF CONSTRUCTION. CHANGE ORDERS NEED TO BE APPROVED BY GOOD VETS CONSTRUCTION MANAGER FOR ISSUES ARISING FROM THE FIELD CONDITIONS OR CONFLICTS BETWEEN THE PLANS AND THE EXISTING CONDITIONS PRIOR TO THE COMMENCEMENT OF WORK.

DATE	ISSUE
11.01.24	CLIENT/LL REVIEW SET

DATE	REVISION
------	----------



GoodVets

LOCATION:

PROJECT INFORMATION:

PROJECT NUMBER: 11478-24
DRAWN BY: NYE
REVIEWED BY: NYE
AREA: 3,377 SQ. FT.

TITLE:

SPRINKLER
DETAILS

SHEET NUMBER:

SP-501.00

RESERVED FOR DOB: