

PLUMBING KEYNOTES

- ① EXTEND AND CONNECT NEW 1-1/2" CW PIPING TO EXISTING CW LINE. CONTRACTOR TO CONFIRM WATER SUBMETER, BACKFLOW PREVENTER REQUIREMENTS WITH LANDLORD. CONTRACTOR TO FIELD VERIFY SIZE, ROUTING AND LOCATION PRIOR TO BID.
- ② PROVIDE HOT WATER MIXING VALVE (TMV-1). SET MAX. OUTLET TEMP. AT 110°F.
- ③ TRAP PRIMER (TP-1) EXTEND AND CONNECT 1/2" TRAP PRIMER PIPING TO FLOOR DRAINS WITH TRAP PRIMER CONNECTIONS. COORDINATE ROUTING.
- ④ CONTRACTOR TO INSTALL NEW EXPANSION TANK AMTROL MODEL THERM-X-TROL ST-5, 2.0 GAL PER LOCAL CODE REQUIREMENTS.

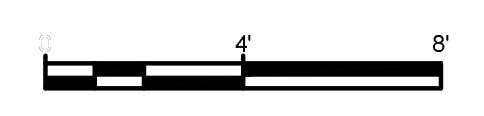
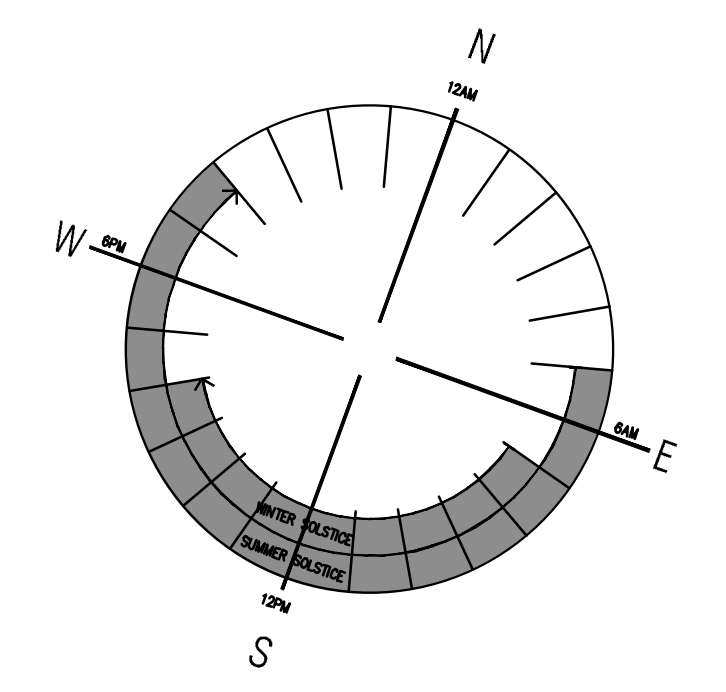
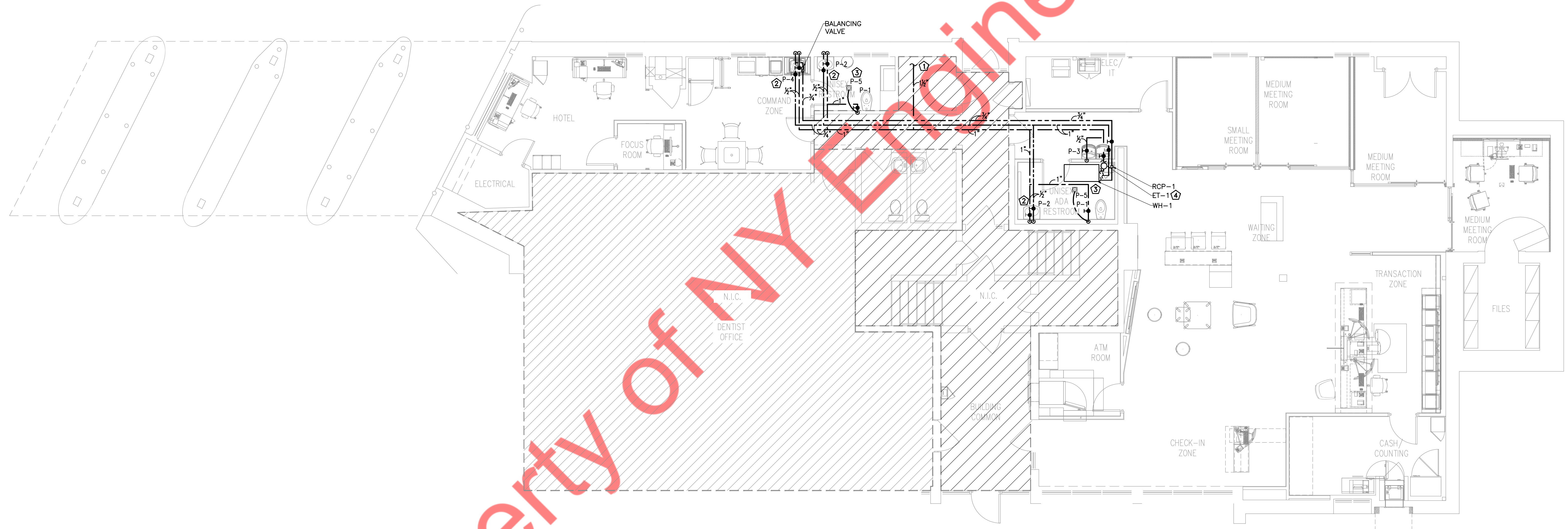

PLUMBING KEYNOTES

- ① CONNECT NEW 4" SANITARY WASTE PIPING TO EXISTING SANITARY WASTE PIPE OF ADEQUATE SIZE. CONTRACTOR TO FIELD VERIFY SIZE, ROUTING AND INVERT ON SITE.
- ② CONNECT NEW 3" VENT PIPE TO EXISTING 4" VTR. CONTRACTOR TO FIELD VERIFY SIZE AND LOCATION.

