

POWER GENERAL NOTES	
1.	INSTALL ALL PIPE, ETC. AS HIGH AS POSSIBLE.
2.	COORDINATE ALL WORK WITH OTHER TRADES AND EXISTING CONDITIONS AS REQUIRED TO PROPERLY INSTALL ALL SYSTEMS AS INTENDED, WITHIN THE CONFINES OF THE SPACE AVAILABLE, AND WITHOUT INTERFERENCES.
3.	REFER TO ARCHITECTURAL DRAWINGS FOR EXACT LOCATIONS AND MOUNTING HEIGHTS OF FIXTURES.
4.	NO PIPING SHALL BE ROUTED OVER THE TOP OF THE ELECTRICAL PANELS.
5.	ALL MATERIALS EXPOSED WITHIN PLENUMS SHALL BE NONCOMBUSTIBLE OR SHALL HAVE A FLAME SPREAD INDEX OF NOT MORE THAN 25 AND A SMOKE-DEVELOPMENT INDEX OF NOT MORE THAN 50 WHEN TESTED IN ACCORDANCE WITH ASTM E84.
6.	GC TO PROVIDE ELECTRICAL DISCONNECTS PER LOCAL AND/OR STATE CODES TO ALL SIGNS. COORDINATE WITH SIGN VENDOR PRIOR TO INSTALLATION.
7.	LIGHT SWITCHES, OUTLETS, AND ALL COVER PLATES TO BE ALMOND IN COLOR.

POWER KEY NOTES	
1	PROVIDE (2) SEPARATE IG 20 AMP CIRCUITS TO DUPLEX RECEPTACLES ON POWER POLE. POWER POLE TO BE WIRE MOLDING (WM 25D1D-4D). POWER POLE SHALL NOT BE PERMANENTLY ANCHORED UNTIL TENANT MILLWORK IS COMPLETE.
2	PROVIDE (7) CAT5 LINES FROM DVR CABINET TO J-BOX. PROVIDE EXTRA 40 FEET OF CABLE AT J-BOX. PROVIDE EXTRA 20 FEET OF CABLE AT DVR CABINET.
3	PROVIDE (1) CAT5 LINE FROM DEMARQ TO DVR CABINET. PROVIDE EXTRA 20 FEET OF CABLE AT EACH END.
4	(1) IG RECEPT AT 4'-0" AFF AND (1) IG RECEPT AT 8'-0" AFF..
5	COORDINATE EXACT ELECTRICAL REQUIREMENTS WITH ACTUAL EQUIPMENT IN FIELD PRIOR TO INSTALLATION.
6	RECEPTACLE MOUNTED 6" ABOVE THE TOP OF THE STOREFRONT WINDOW PER NEC.
7	EXISTING ELECTRICAL DETAILS: PANEL 'A' - 120/208V-3PH-4W 30 POLES PANEL 'B' - 120/208V-3PH-4W 30 POLES REFER TO RISER DIAGRAM FOR MORE INFORMATION.
8	30 AMP DISCONNECT SWITCH WITH LOCK-OFF CAPABILITY FOR STOREFRONT SIGN. VERIFY EXACT LOCATION AND ELECTRICAL REQUIREMENTS FOR CONNECTION TO STOREFRONT SIGN.
9	PET VALU VENDOR TO PROVIDE OUTLETS AND SWITCH IN MODULAR DOG WASH STATION.
10	DUPLEX RECEPTACLE FOR GAS FIRED HOT WATER HEATER. CONTRACTOR TO VERIFY EXACT LOCATION IN FIELD.
11	NEMA 14-30R 30AMP 220V RECEPTACLE FOR DRYER TO BE MOUNTED AT 60" A.F.F.
12	DUPLEX RECEPTACLE FOR WASHER MOUNTED AT 36" A.F.F.
13	THERMOSTAT FOR RTU-1. REFER TO MECHANICAL DRAWINGS FOR MORE INFORMATION.
14	RECEPTACLE FOR TELEPHONE. CONTRACTOR TO VERIFY EXACT LOCATION IN FIELD.
15	PET VALU G.C. TO PROVIDE AND INSTALL POWER FOR FREEZER.
16	SINGLE CAT5e LINE FROM DVR CABINET TO LOW VOLTAGE BOX AT 86" AFF BY TV OUTLET. 10' COIL AT LOW VOLTAGE BOX AND 20' COIL AT DVR CABINET.
17	JUNCTION BOX TO BE MOUNTED ON CEILING. CONDUIT AND WIRE FOR OUTLET TO BE INSTALLED ON FIXTURE AT 80" A.F.F. AFTER FIXTURE INSTALLATION. GC TO COORDINATE LOCATION AND TIMING WITH PET VALU CONSTRUCTION MANAGER.

NOTE:  
CONSTRUCTION DOCUMENTS ARE BASED ON A SET OF DRAWINGS AND/OR INFORMATION PROVIDED BY PET VALU. SARGENT ARCHITECTS AND SARGENT'S ENGINEER SHALL NOT BE HELD RESPONSIBLE FOR ANY DISCREPANCIES BETWEEN THE DRAWINGS AND FIELD CONDITIONS.

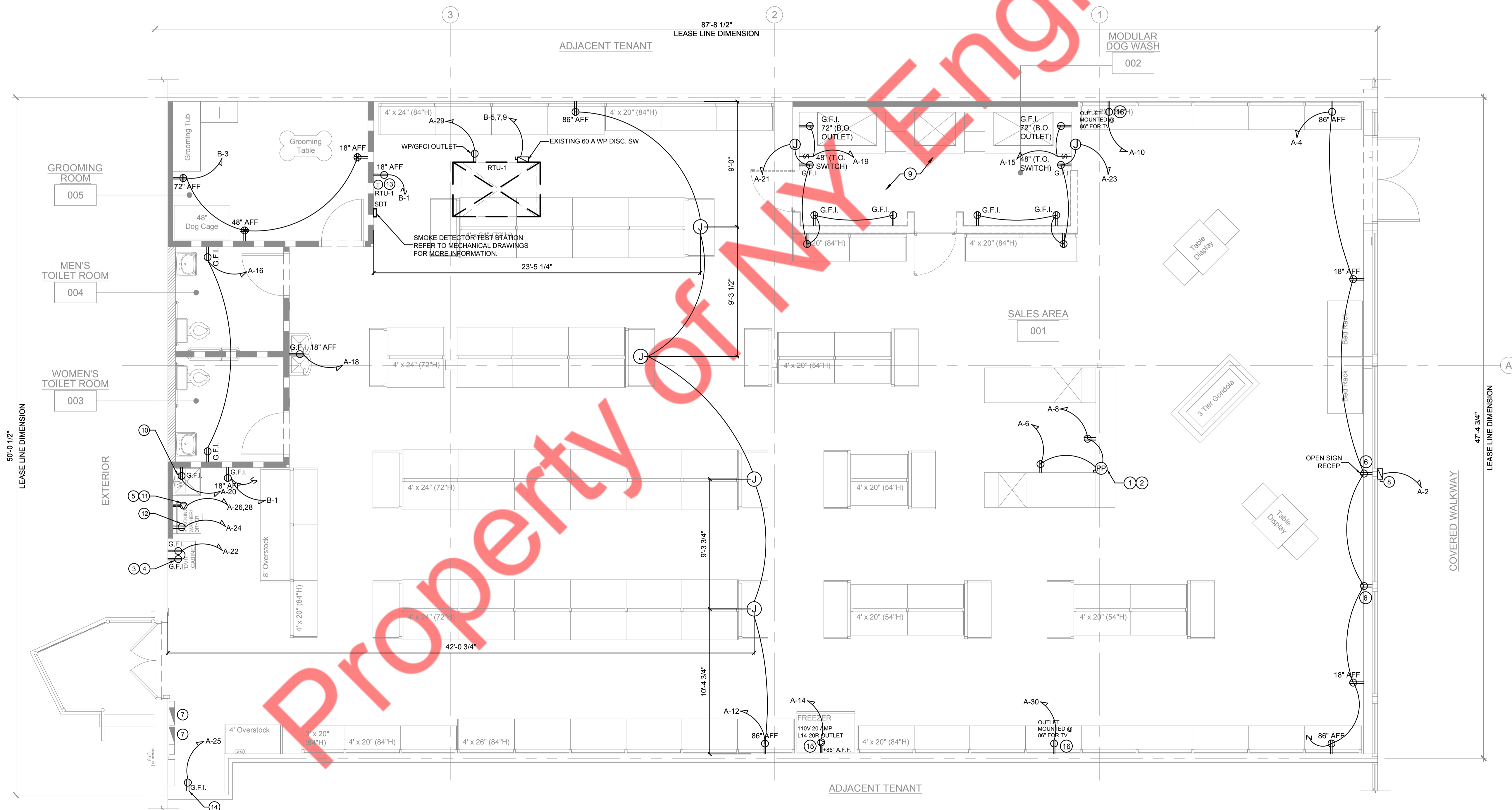

**1** LIGHTING NOTE:  
 NEC 2014 SECTION 700.12 (F)  
 ALL UNIT EQUIPMENT (EMERGENCY LIGHTING) SHALL BE WIRED AHEAD OF SWITCH OR CONTROL OF NORMAL LIGHTING CIRCUIT SERVING THAT AREA. THE BRANCH CIRCUIT FEEDING THE UNIT EQUIPMENT SHALL BE THE SAME BRANCH CIRCUIT AS THAT SERVING THE NORMAL LIGHTING IN THE AREA AND CONNECTED AHEAD OF ANY LOCAL SWITCHES. THE BRANCH CIRCUIT THAT FEEDS UNIT EQUIPMENT SHALL BE CLEARLY IDENTIFIED AT THE DISTRIBUTION PANEL.  
 IN A SEPARATE AND UNINTERRUPTED AREA SUPPLIED BY A MINIMUM OF THREE NORMAL LIGHTING CIRCUITS, A SEPARATE BRANCH CIRCUIT FOR UNIT EQUIPMENT SHALL BE FROM THE SAME PANELBOARD AS THAT OF THE NORMAL LIGHTING CIRCUITS AND PROVIDED WITH A LOCK-ON FEATURE.

CONTRACTOR TO FURNISH AND INSTALL CURRENT LIMITERS TO LIMIT THE WATTAGE AVAILABLE FOR THE TRACK. CONTRACTOR TO UTILIZE CON-TECH LIGHTING LA-23-R (TITLE 24 COMPLIANT-CALIF. ONLY) OR LA-23-RN (NON-TITLE 24 COMPLIANT) CURRENT LIMITING DEVICE OR EQUIVALENT.

CON-TECH CURRENT LIMITING DEVICES		
REG-05	60W	0.5A
REG-1	120W	1A
REG-2	210W	1.75A
REG-21	240W	2A
REG-3	300W	2.5A
REG-4	360W	3A
REG-5	480W	4A
REG-6	600W	5A
REG-7	720W	6A
REG-8	840W	7A
REG-9	900W	7.5A
REG-91	960W	8A
REG-10	1,200W	10A
REG-12	1,440W	12A
REG-14	1,680W	14A

- ### LIGHTING KEYED NOTES
- NEW TRACK LIGHTING. CONNECT TO CIRCUITS INDICATED. PROVIDE (1) SINGLE POLE 20 AMP BREAKER FROM PANEL AS NEEDED FOR A FULLY FUNCTIONING SYSTEM. PROVIDE LOCAL SWITCHING FOR TRACK LIGHTING PER CIRCUIT AT LOCATION OF SWITCH BANK. COORDINATE LOCATION WITH PROJECT MANAGER PRIOR TO ANY WORK.
  - SPEAKER WIRED WITH 14 GA. SPEAKER CABLE TO DVR CABINET LOCATION. PROVIDE 20 FEET OF CABLE AT DVR CABINET SPEAKER TO BE:  
 OPEN CEILING: YAMAHA NS-AW150 BLACK OR SIMILAR.  
 GRID CEILING: LEGRAND 364764-02-V 6.5" SPEAKERS TO BE SUPPLIED AND INSTALLED BY G.C.  
 MAXIMUM (2) TWO SPEAKER TO BE INSTALLED ON ANY SINGLE CHANNEL.
  - PROVIDE WALL MOUNTED, ULTRASONIC OCCUPANCY SENSOR WITH MANUAL BY-PASS.
  - MASTER LIGHTING SWITCH BANK. COORDINATE LOCATION OF SWITCHES WITH CONSTRUCTION MANAGER. REFER TO SHEET E3.0 DETAIL #2 FOR SWITCH DESIGNATION.
  - SWITCH FOR DOG WASH EXHAUST FAN. COORDINATE EXACT LOCATION WITH PET VALU CONSTRUCTION MANAGER.

- ### LIGHTING GENERAL NOTES
- REFER TO ARCHITECTURAL REFLECTED CEILING PLAN FOR EXACT FIXTURE LOCATIONS.
  - REFER TO LIGHTING FIXTURE SCHEDULE ON SHEET E3.0 FOR FIXTURE SPECIFICATIONS.
  - FINAL ARRANGEMENT OF EACH FIXTURE (AIMING) SHALL BE PROVIDED TO THE OWNER REPRESENTATIVE AFTER THE FIXTURE IS INSTALLED.
  - UNLESS NOTED OTHERWISE ON THE PLAN ALL ELECTRICAL LIGHT FIXTURE HEIGHTS SHALL BE FOLLOWED PER THE LIGHTING FIXTURE SCHEDULE.
  - ALL EMERGENCY LIGHTING AND EXIT SIGNAGE SHALL BE CONNECTED AHEAD OF SWITCHING FOR CONTINUOUS OPERATION.
  - PLENUM RATED CABLE TO BE USED WHERE REQUIRED WITHIN PLENUM RATED SPACES ABOVE CEILING.
  - ALL OUTLET AND SWITCH PLATE COVERS TO BE ALMOND.

NOTE:  
 CONSTRUCTION DOCUMENTS ARE BASED ON A SET OF DRAWINGS AND/OR INFORMATION PROVIDED BY PET VALU, SARGENTI ARCHITECTS, AND SARGENTI'S ENGINEER SHALL NOT BE HELD RESPONSIBLE FOR ANY DISCREPANCIES BETWEEN THE DRAWINGS AND FIELD CONDITIONS.

